

28° Lt.
FWD. Skew

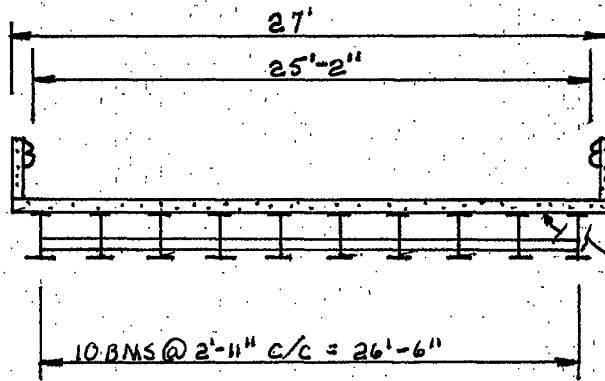

Spans #1 - #3

Note: Felt paper
w/ 6x6 wire mesh
supported by #5
rebar @ 8" o/c ±

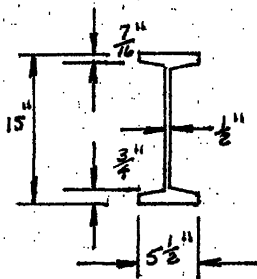

Bms #1-#10

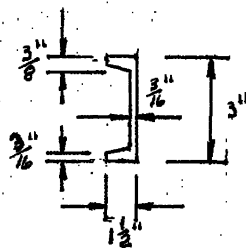

Diaphragms

5 per span w/
variable spacing

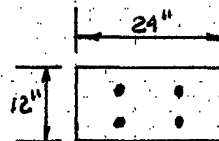

Splice Plate

4 bolts per splice w/
splices vary thru-out but
are in middle 1/3 of a
span.

Insp. RLH & RSR

BRIDGE INSPECTION REPORT — FORM III

Date 2/14/97

Dist. 4 Co. 72 Rt. 28 Sec. I Log 0.05 Br. No. 18313

CGT