

Layout

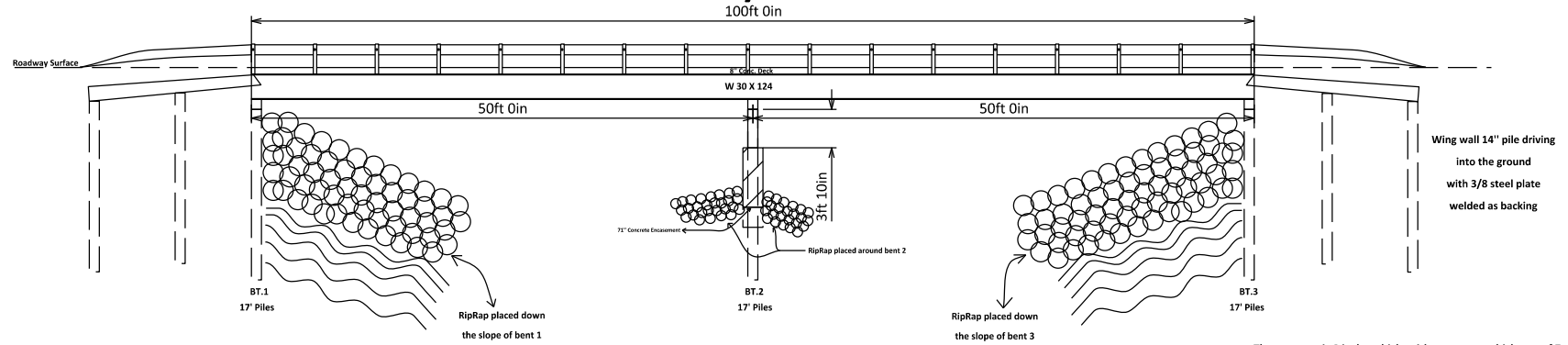

The concrete is 8 inches thick, with an average thickness of 7.5 inches.

The rebar is spaced every 12 inches.

The steel beams are W30 x 124#.

All the 14-inch steel pipes are filled with concrete.

Riprap and concrete are placed at the end supports in the channel and around bent 2.

Bent 2

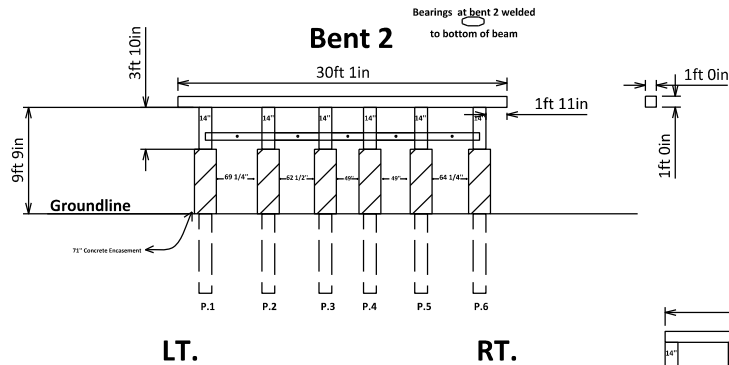

LT.

RT.

Bent 1 & 3

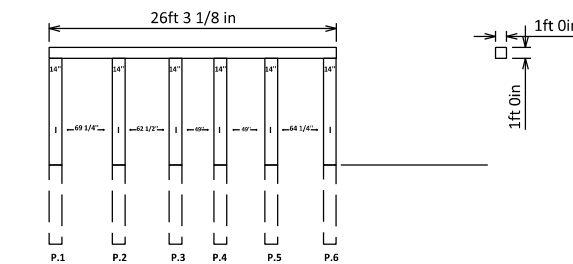

LT.

RT.

Deck End View

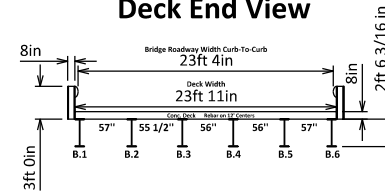

LT.

RT.



BRIDGE NO.

24438

ARKANSAS STATE HIGHWAY COMMISSION
Little Rock, ARK.

Scale: 1"=12'

Inspection Dir: E To W

Channel Flow: N To S

Drawn By: D.Calhoun

Checked By: J.King

Project: Layout

Date: 20251209

