

Looking up at Bottom Flange of girders  
showing portions cut-away and section loss  
[ As built condition ]

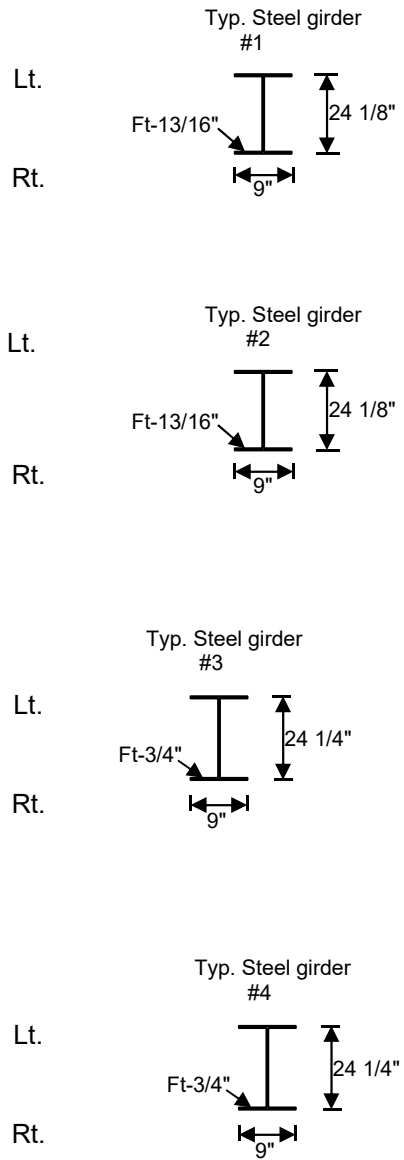
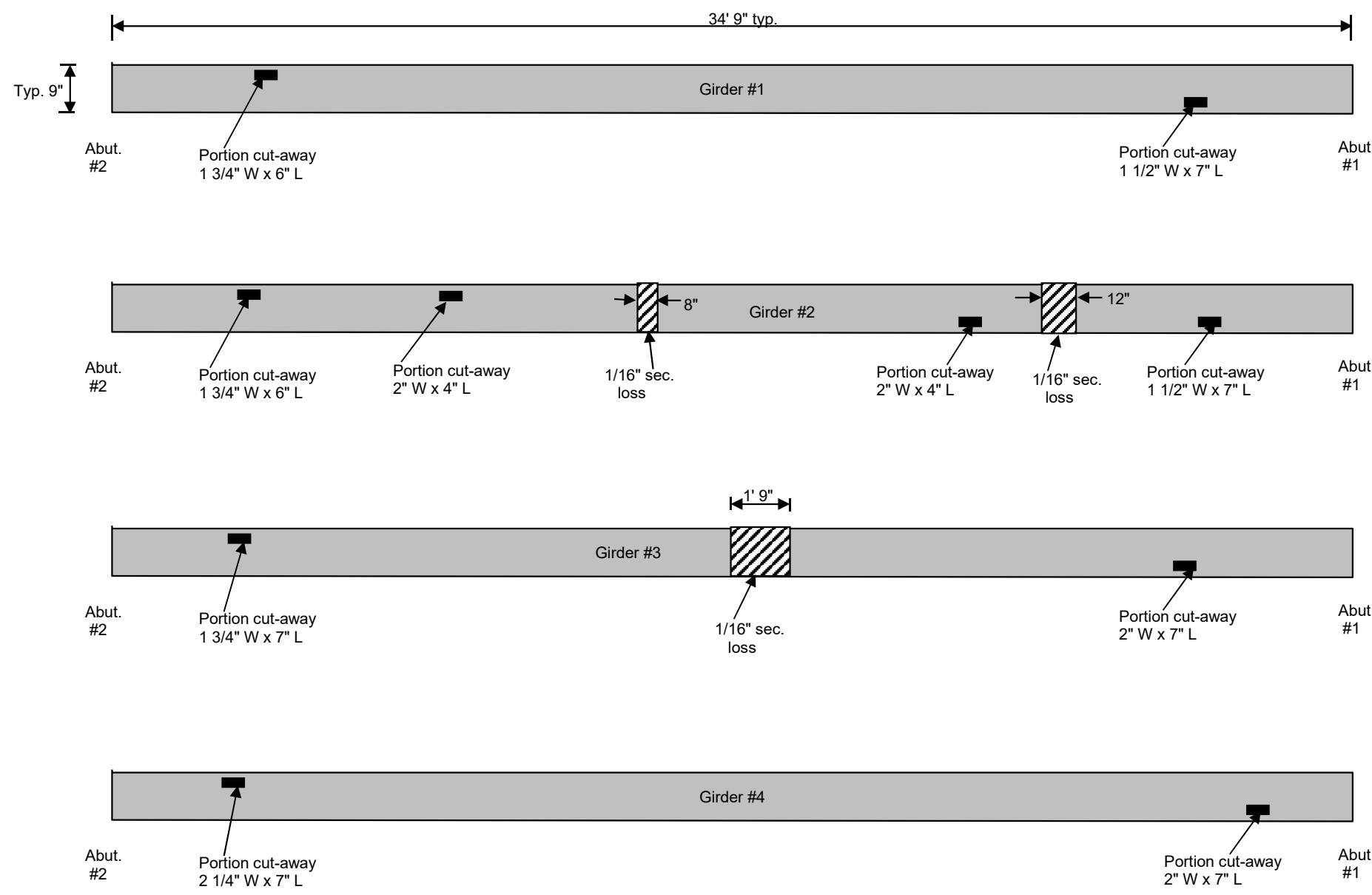

Insp. JEF & HGJ  
Date 09/25/2013  
Dist. 09 Co. 44/Madison

Rt.0180

Sec. 00/F Log 05.250

Br. # 22420

Looking up at Bottom Flange of girders  
showing portions cut-away and section loss  
[ As built condition ]

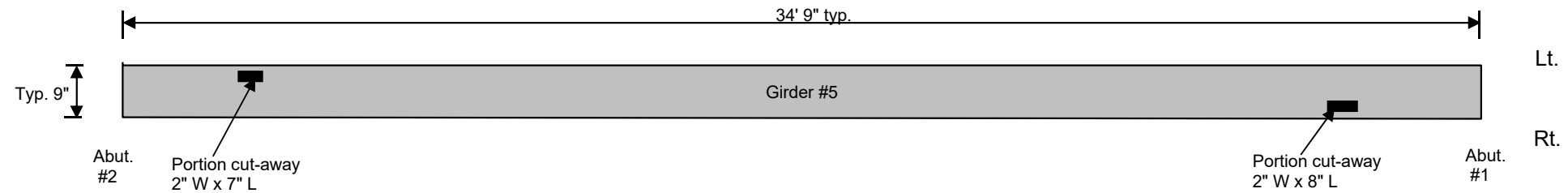

Lt.  
Rt.

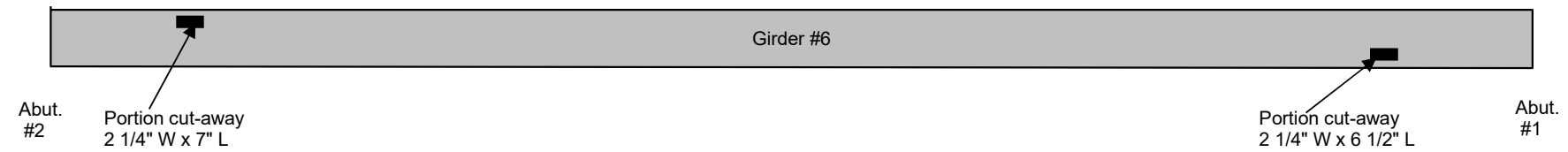
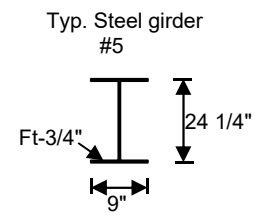

Lt.  
Rt.

