

RIGHT OF WAY DATA				
Sta	To	Sta	Rt. of Way	Left of Way
483+00	Back	40'	40'	
483+00	Ahead	50'	50'	
490+00	Ahead	40'	40'	

FED. ROAD No.	STATE	FISCAL YEAR	SHEET NO.	TOTAL SHEETS
6	ARK.	5-437(4)	37	185
JOB No.		1267		

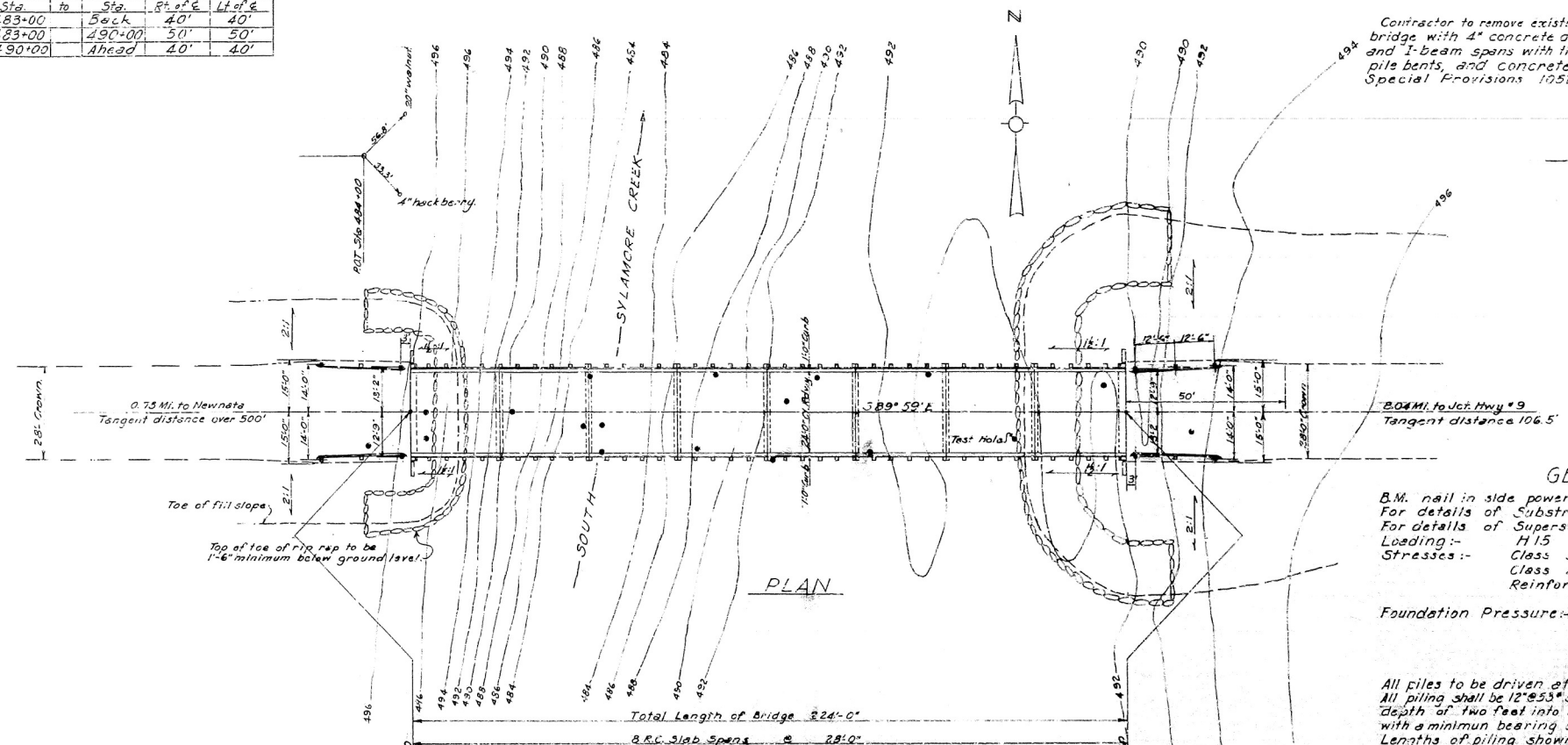

GENERAL NOTES

B.M. nail in side power pole 180' left Sta. 483+40. Elev. 496.15'.
 For details of Substructure see Drawgs. Nos. 5491 & 5492A
 For details of Superstructure see Drawgs. Nos. 5492 & 9108
 Loading:- H-15 A.A.S.H.O. 1953.
 Stresses:- Class 3 Conc. (n=10) 1200%
 Class 4 Conc. (n=15) 840%
 Reinforcing Steel 20,000%
 Foundation Pressure:- 7200 p.s.f.

PILING NOTES

All piles to be driven after embankment is in place.
 All piling shall be 12"x53" steel bearing piles, driven to refusal or to a minimum depth of two feet into the material designated as solid rock on the boring logs with a minimum bearing capacity of 30 tons per pile.
 Lengths of piling shown are for estimating purposes only. Actual lengths shall be ordered on either of the following alternates at the option of the Contractor.
 ALTERNATE-A. After the Contractor has driven a test pile in each of bents 1 & 9 the Engineer shall furnish an order list to the Contractor. Payment shall be made for the net length of pile in place with allowances made for cut-off and splicing as set out in the Special Provisions.
 ALTERNATE-B. The Contractor shall assume the responsibility for determining pile lengths, in which case payment shall be made for the net length of pile in place with no allowance nor payment for cut-offs or splicing. Measurement for payment shall not include lengths driven beyond the minimum requirements for penetration into the rock, and capacity per pile. Unless specifically authorized in writing by the Engineer, not more than one splice per pile shall be permitted.

Lengths of test piles under alternate A to be 28 feet at bent 1 and 32 feet at bent 9.

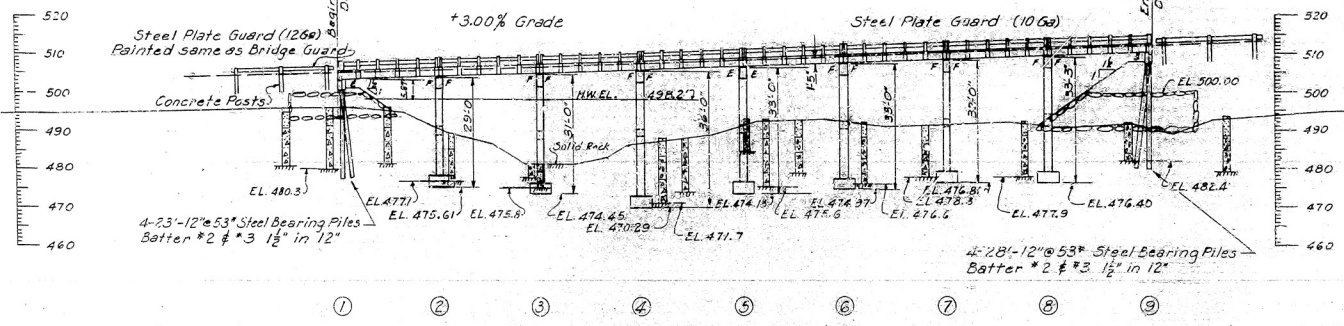

LEGEND

- Firm sandy clay
- Firm clay, gravel & boulders
- Compact clay, gravel & boulders
- Top of solid rock.

LAYOUT OF BRIDGE OVER
 SOUTH SYLAMORE CREEK
 HARNESS MOUNTAIN-EAST & WEST
 STONE COUNTY
 ROUTE 66 SEC.2
 ARKANSAS STATE HIGHWAY COMMISSION
 LITTLE ROCK, ARK.

DRAWN BY: W.E.W. DATE: 5-16-56
 TRACED BY: DATE: 5-21-56
 CHECKED BY: J.E.M. DATE: 5-21-56
 BRIDGE NO. 892 DRAWING NO. 9110
 SCALE: 1" = 20'

L.P. Carlson
 BRIDGE DESIGN ENGINEER