

**SALT PROJECT # 05-21-02  
ARDOT PROJECT # 050467  
Quitman Sidewalks Ph. 4 (TAP-20)(S) 2026**

### **ADDENDUM #1**

Addendum #1 is issued to the above referenced Project Bidding Documents, which is scheduled for bid opening at 10 a.m. on Thursday, June 25, 2026. To be considered a Responsive Bidder, the Bidder must acknowledge all addenda with the submitted Bid Form.

The following changes have been made to the Bidding Documents:

#### **PLANS**

**Summary of Change:** *The solar lights and poles were changed to a Build America, Buy America Act (BABAA) certified product.*

**Revise the Plan set by replacing the original Sheet 6 (in its entirety) with the attached Sheet 6A, that specifies the solar lights to be Grid Shift CS-COA-2020-32-10W and the pole to be Grid Shift 10' CS-BC-124 pole.**

*To comply with ADA standards, the height of the non-slip edge protection curb along the sidewalks shall be increased to a minimum of 4 inches.*

**Revise the Plan Set by replacing the original Sheet 9 (in its entirety) with the attached Sheets 9A, that specifies on Detail B, Note 5 and Detail E, Note 2 that the minimum curb height is 4".**

**Revise the Plan Set by replacing the original Sheet 10 (in its entirety) with the attached Sheets 10A, that specifies on Detail C, Note 2 that the minimum curb height is 4".**

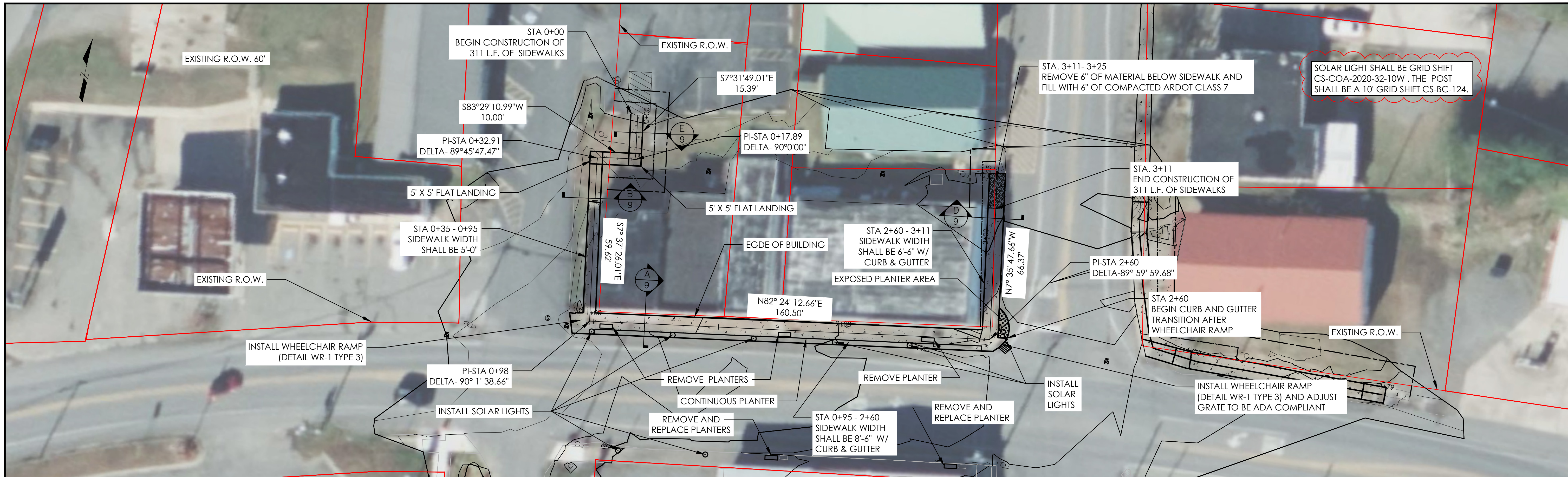

SOLAR LIGHT SHALL BE GRID SHIFT CS-COA-2020-32-10W . THE POST SHALL BE A 10' GRID SHIFT CS-BC-124.

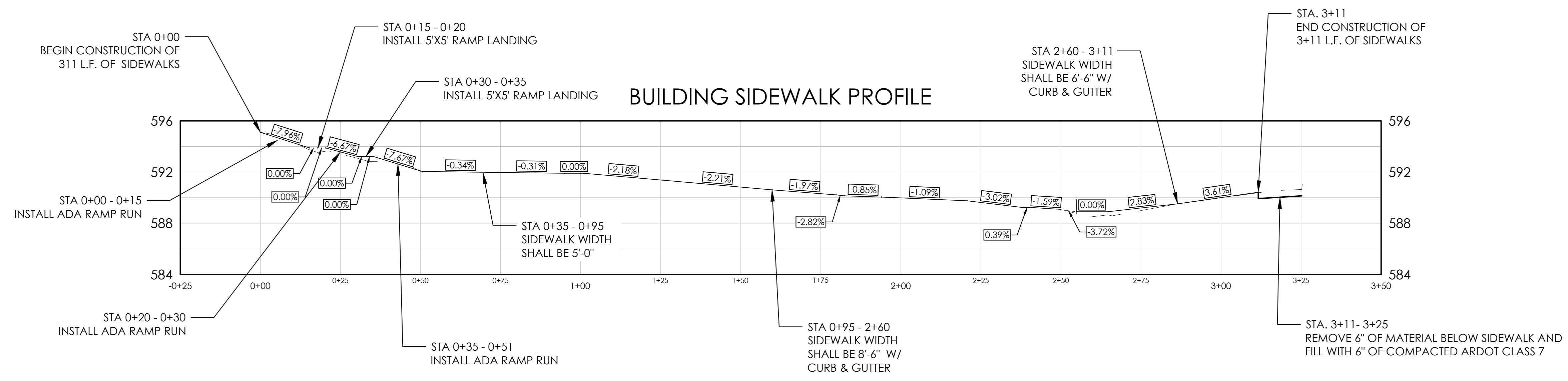

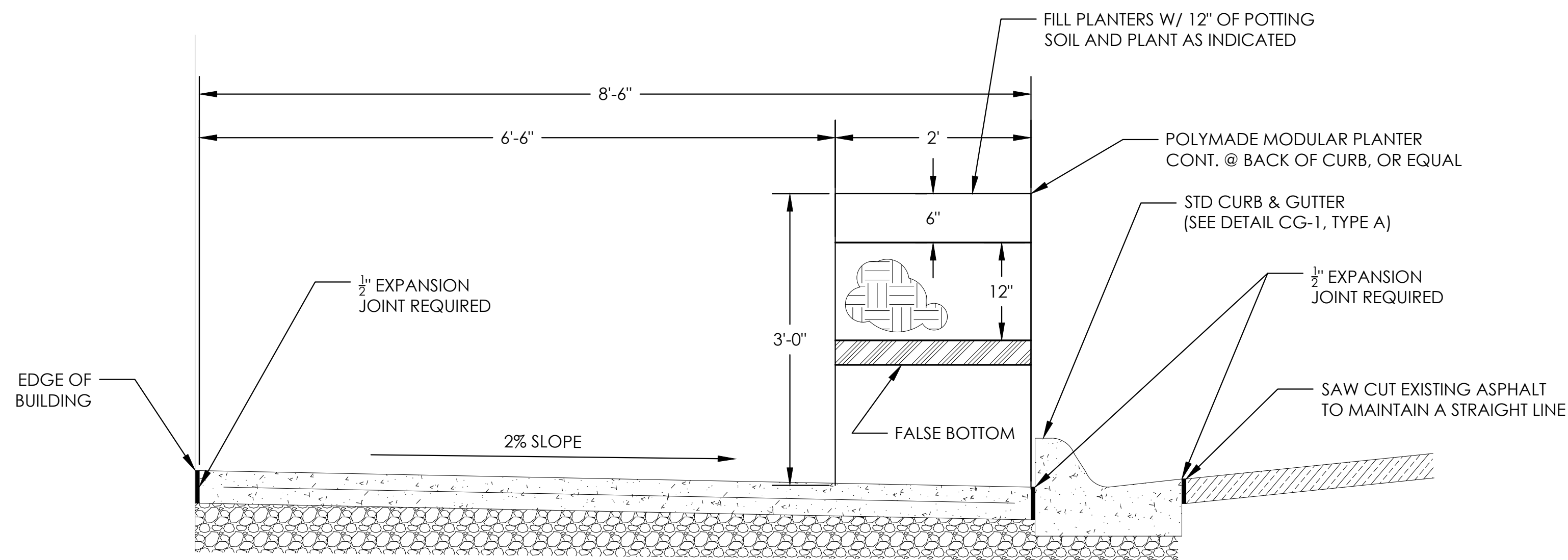

NOTE:  
EDGE PLANTER W/ BLUE FESCUE (ELISHA BLUE)  
AND CENTER PLANT 2' STRIPS OF ALTERNATING:  
1) TALL SEDUM  
2) SALVIA  
3) PURSLANE

NOTE 1:  
SIDEWALK FROM STA. 0+95 - 2+60  
ON BUILDING SIDEWALK PROFILE

**8'-6" SIDEWALK WITH CURB & GUTTER DETAIL A**  
SCALE: 1" = 1'-0"

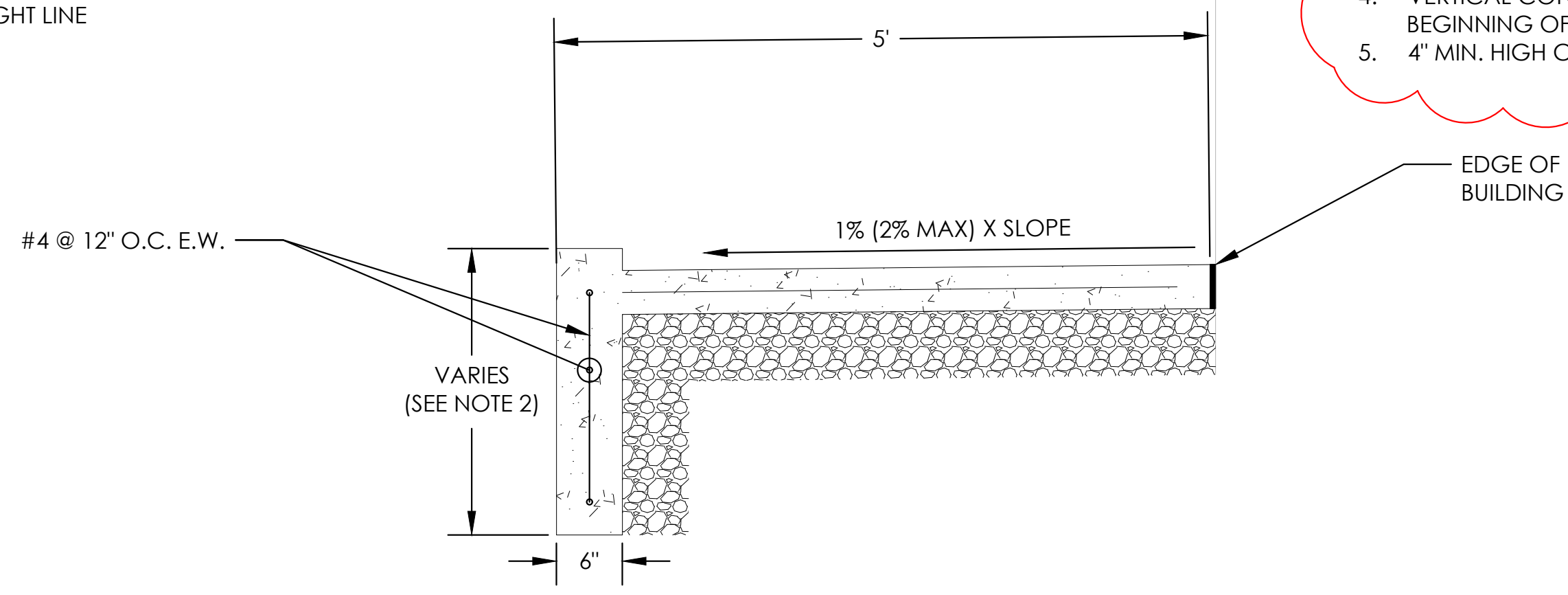

NOTE 2:  
1. SLOPE LONGITUDINALLY (NORTH) AT 0.04% FROM HWY 25 (STA. 0+95) TO BEGINNING OF RAMP ON DETAIL C.  
2. AT STA. 0+95 THE WALL HEIGHT IS 2', DECREASING TO 1' @ STA. 0+65, WHERE IT IS TERMINATED.  
3. HORIZONTAL CONTROL IS THE EDGE OF BUILDING.  
4. VERTICAL CONTROL POINT IS THE BEGINNING OF RAMP (SEE DETAIL C).  
5. 4" MIN. HIGH CURB

**5'-0" SIDEWALK AT BUILDING EDGE DETAIL B**  
SCALE: 1" = 1'-0"

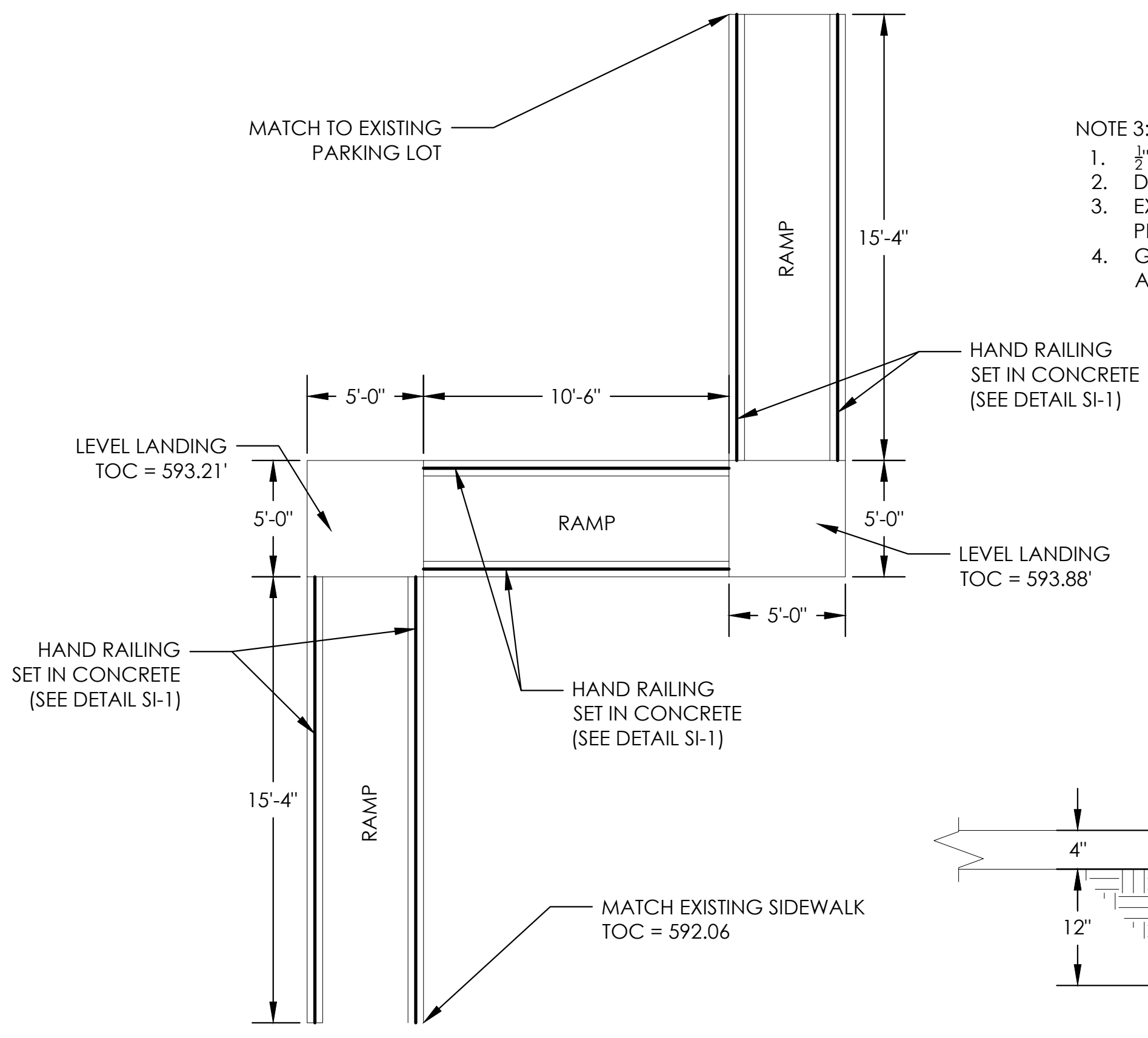

NOTE 3:  
1. 1/2" EXPANSION JOINT SPACING AT 60' OR ADJACENT TO STRUCTURES  
2. DOWEL BARS WITH EXPANSION JOINT MATERIAL REQUIRED AT INLET EXPANSION JOINT SHALL BE INSTALLED BETWEEN PUBLIC AND PRIVATE SIDEWALKS, BUILDINGS, OR ROADS  
3. GRADING OF EXISTING GROUND TO SIDEWALK MUST BE GRADED AT A SLOPE THAT CAN BE EASILY MAINTAINED AND/OR MOWED.

**PARKING LOT RAMP DETAIL C**  
SCALE: 1/4" = 1'-0"

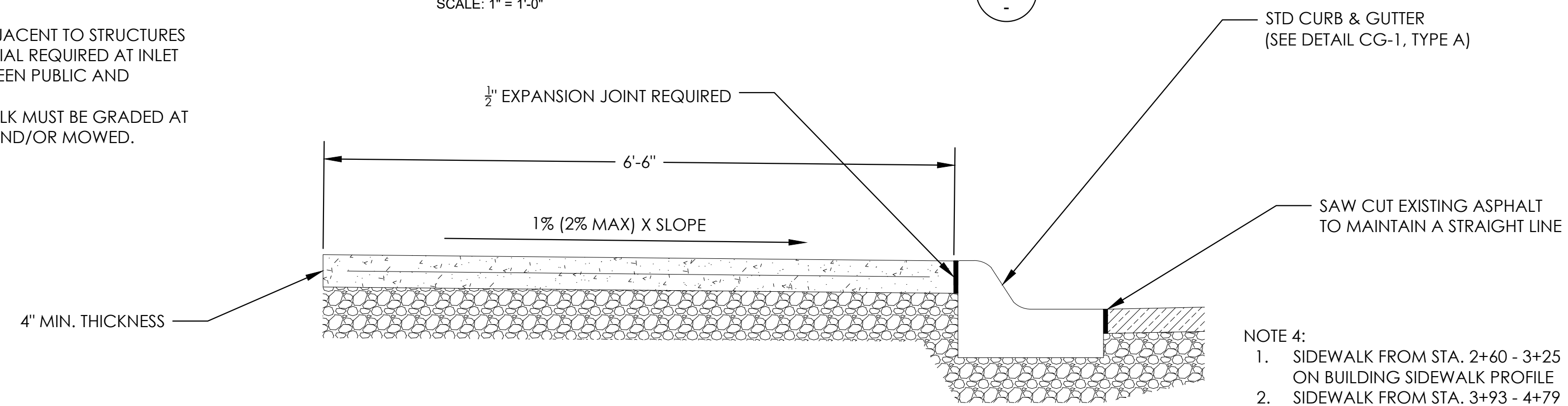

NOTE 4:  
1. SIDEWALK FROM STA. 2+60 - 3+25 ON BUILDING SIDEWALK PROFILE  
2. SIDEWALK FROM STA. 3+93 - 4+79 ON EAST SIDEWALK PROFILE

**6'-6" SIDEWALK WITH CURB & GUTTER DETAIL D**  
SCALE: 1" = 1'-0"

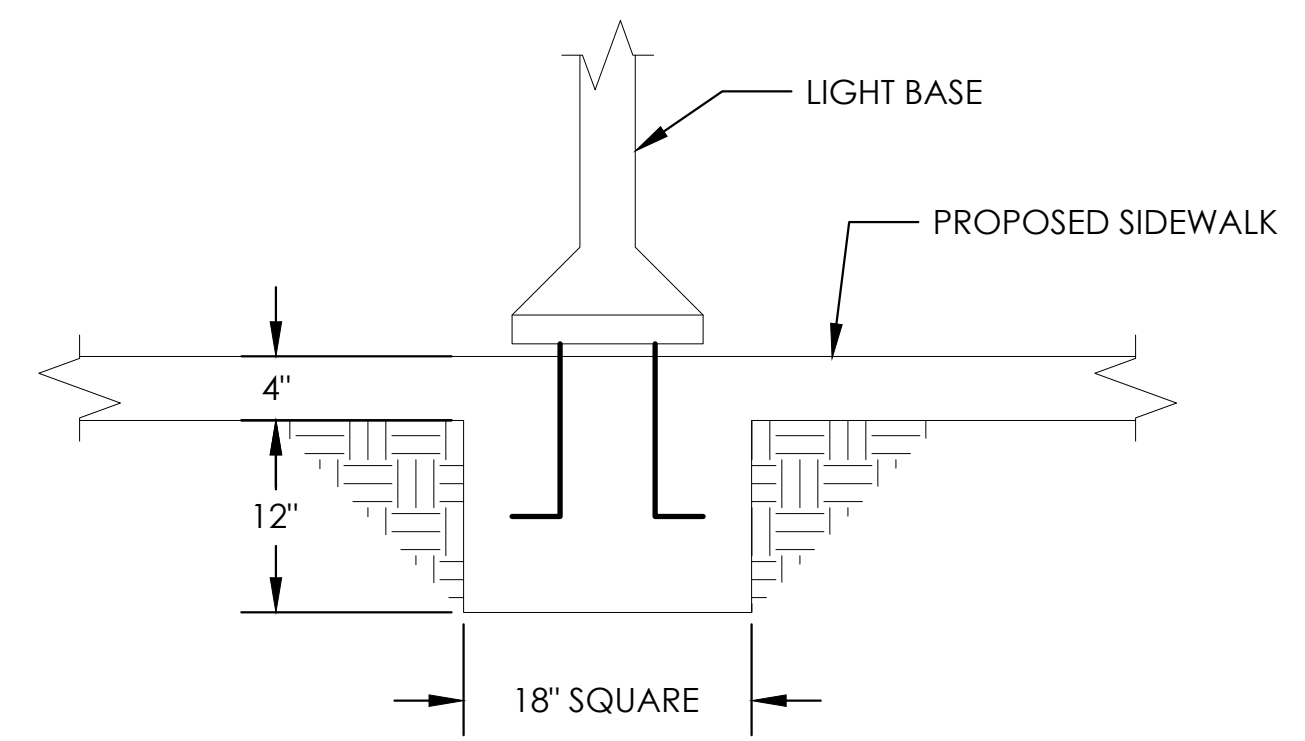

**LIGHT BASE FOUNDATION DETAIL F**  
SCALE: N.T.S.

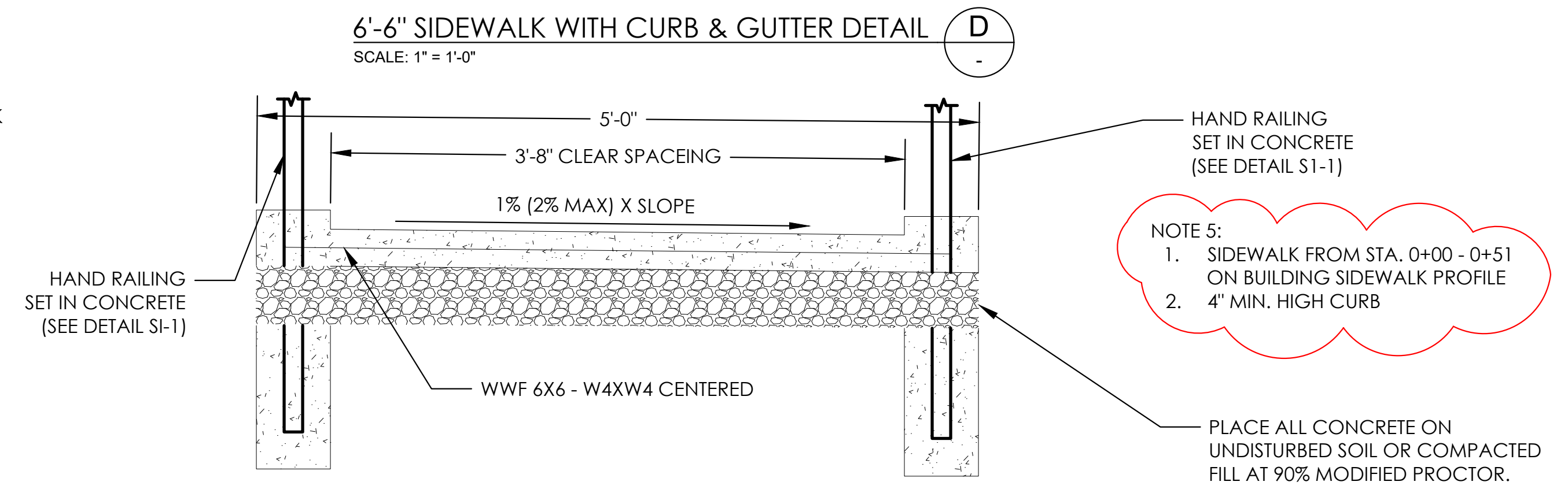

NOTE 5:  
1. SIDEWALK FROM STA. 0+00 - 0+51 ON BUILDING SIDEWALK PROFILE  
2. 4" MIN. HIGH CURB

**PARKING LOT RAMP SIDEWALK DETAIL E**  
SCALE: N.T.S.

STA. 3+25  
BEGINNING OF LANDING  
TOC = 590.51'±  
MATCH EXISTING GRADE

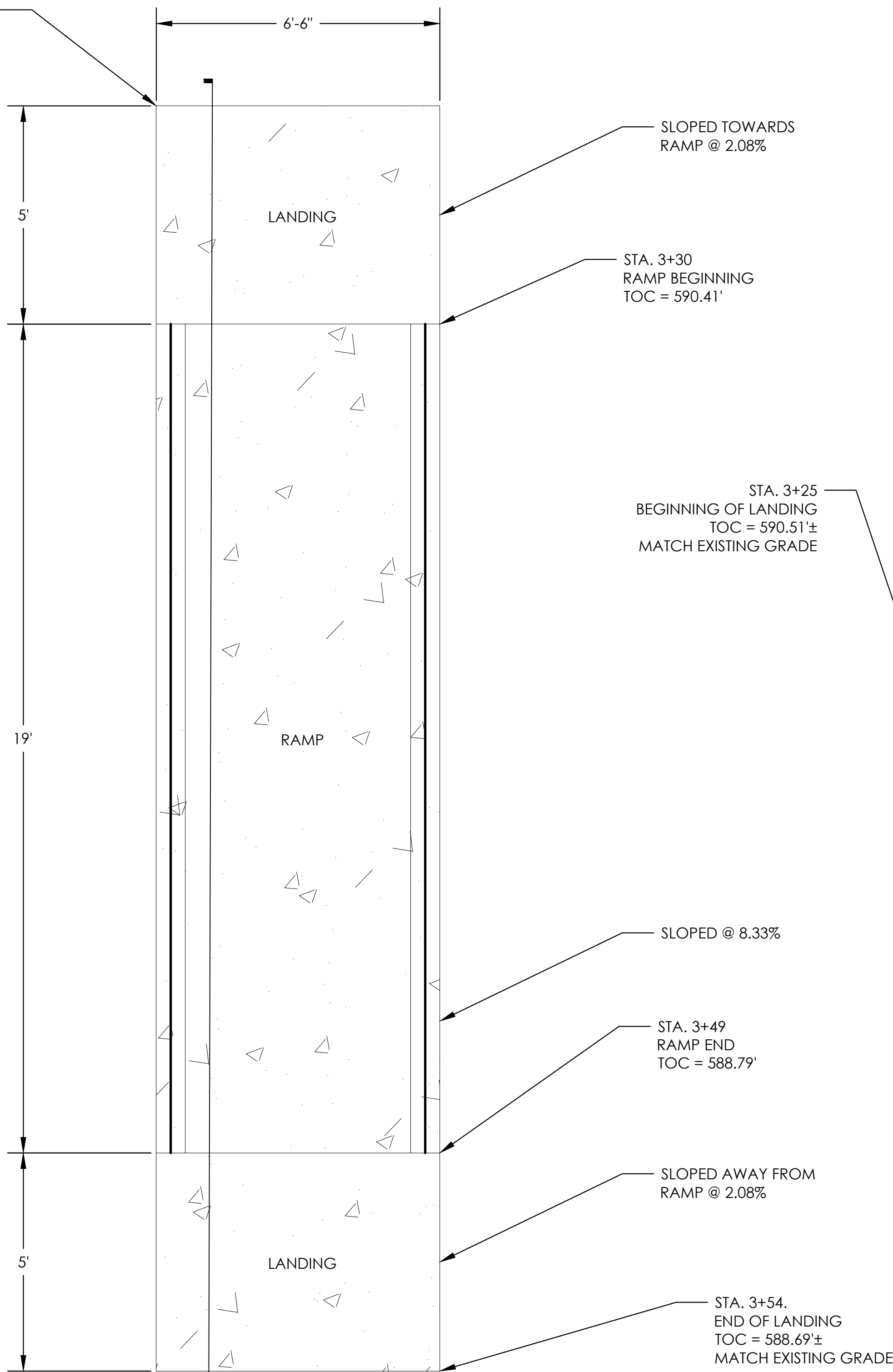

**PLAN**  
EAST SIDEWALK RAMP DETAIL (A)  
SCALE: 1/2" = 1'-0"

SLOPED TOWARDS  
RAMP @ 2.08%

STA. 3+30  
RAMP BEGINNING  
TOC = 590.41'

STA. 3+25  
BEGINNING OF LANDING  
TOC = 590.51'±  
MATCH EXISTING GRADE

STA. 3+30  
RAMP BEGINNING  
TOC = 590.41'

STA. 3+49  
RAMP END  
TOC = 588.79'

STA. 3+54  
END OF LANDING  
TOC = 588.69'±  
MATCH EXISTING GRADE

CONNECT TO EXISTING SIDEWALK

EXISTING SIDEWALK

SLOPED @ 8.33%

STA. 3+49  
RAMP END  
TOC = 588.79'

SLOPED AWAY FROM  
RAMP @ 2.08%

STA. 3+54  
END OF LANDING  
TOC = 588.69'±  
MATCH EXISTING GRADE

**SECTION**  
EAST SIDEWALK RAMP DETAIL (B)  
SCALE: 1/2" = 1'-0"

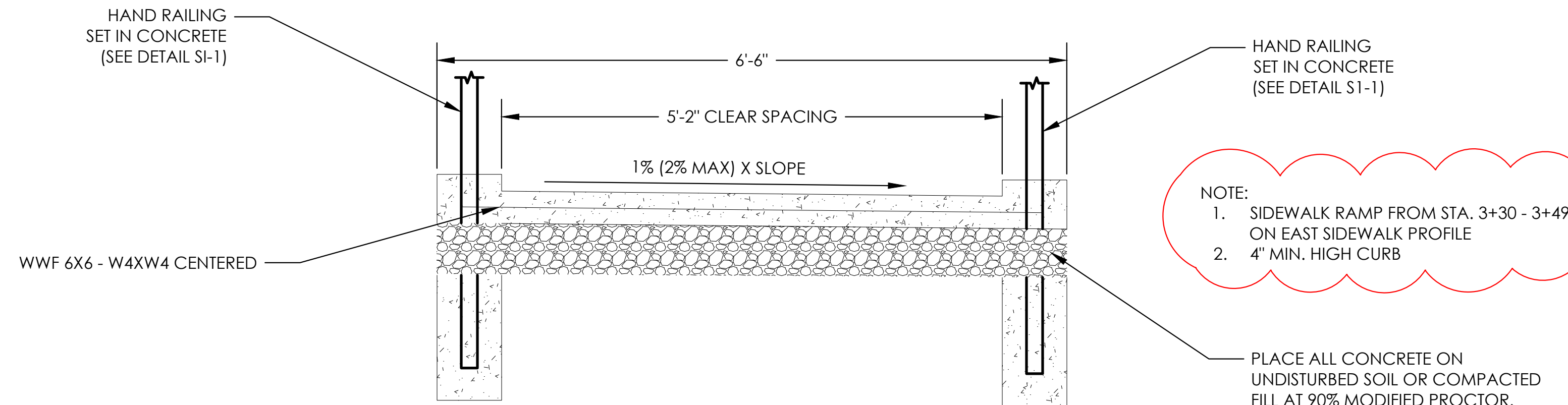

**EAST SIDEWALK RAMP DETAIL** (C)  
SCALE: N.T.S.

NOTE:  
1. SIDEWALK RAMP FROM STA. 3+30 - 3+49  
ON EAST SIDEWALK PROFILE  
2. 4" MIN. HIGH CURB

PLACE ALL CONCRETE ON  
UNDISTURBED SOIL OR COMPACTED  
FILL AT 90% MODIFIED PROCTOR.

**SALT** Engineers & Planners  
saltengineers.com | 870-307-3240  
rcornett@saltengineers.com

SCALE:  
AS SHOWN  
DATE:  
SEPTEMBER 2025

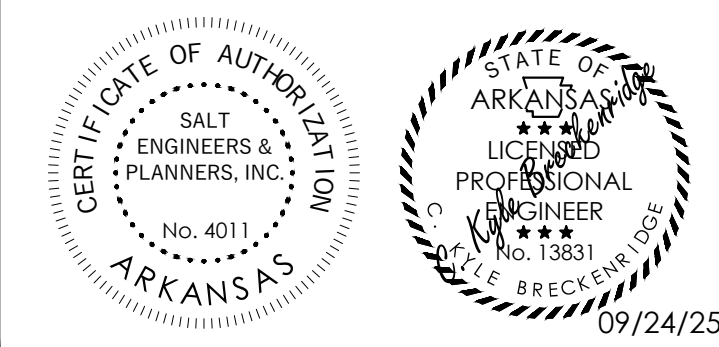

CITY OF QUITMAN  
**PHASE 4 SIDEWALKS**

SIDEWALK RAMP DETAIL	
PROJECT #	SHEET
05-21-02	10A