

FED. ROAD DIST. NO.	STATE	ED. A.D. PROJECT	FISCAL YEAR	SHEET NO.	TOTAL SHEETS
6	ARK.	S-444(3)		24	24
JOB NO.	9439				

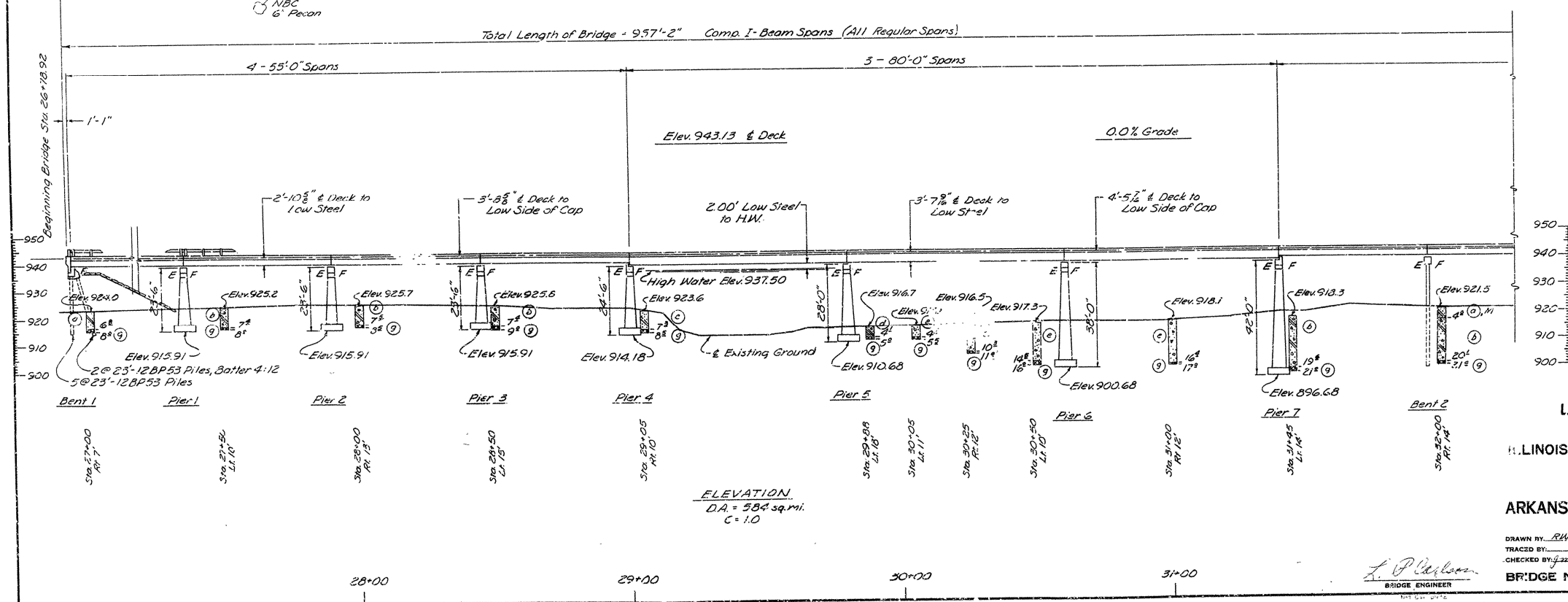

**SHEET 1**  
**LAYOUT OF BRIDGE OVER**  
**ILLINOIS RIVER**  
**ILLINOIS RIVER BRIDGE & APPROACHES**  
**BENTON COUNTY**  
**ROUTE 59 SEC. 2**  
**ARKANSAS STATE HIGHWAY COMMISSION**  
**LITTLE ROCK, ARK.**  
DRAWN BY: *RWM* DATE: *10-3-62*  
TRACED BY: \_\_\_\_\_ DATE: \_\_\_\_\_  
CHECKED BY: *gjm* DATE: *10-8-62*  
BRIDGE NO. 3743 DRAWING NO. 12229  
SCALE: 1" = 20'

FED. ROAD DIST.	STATE	PROJECT	YEAR	SHEET NO.	TOTAL SHEETS
6	ARK	5-444(3)	7	24	
		9438	7	24	

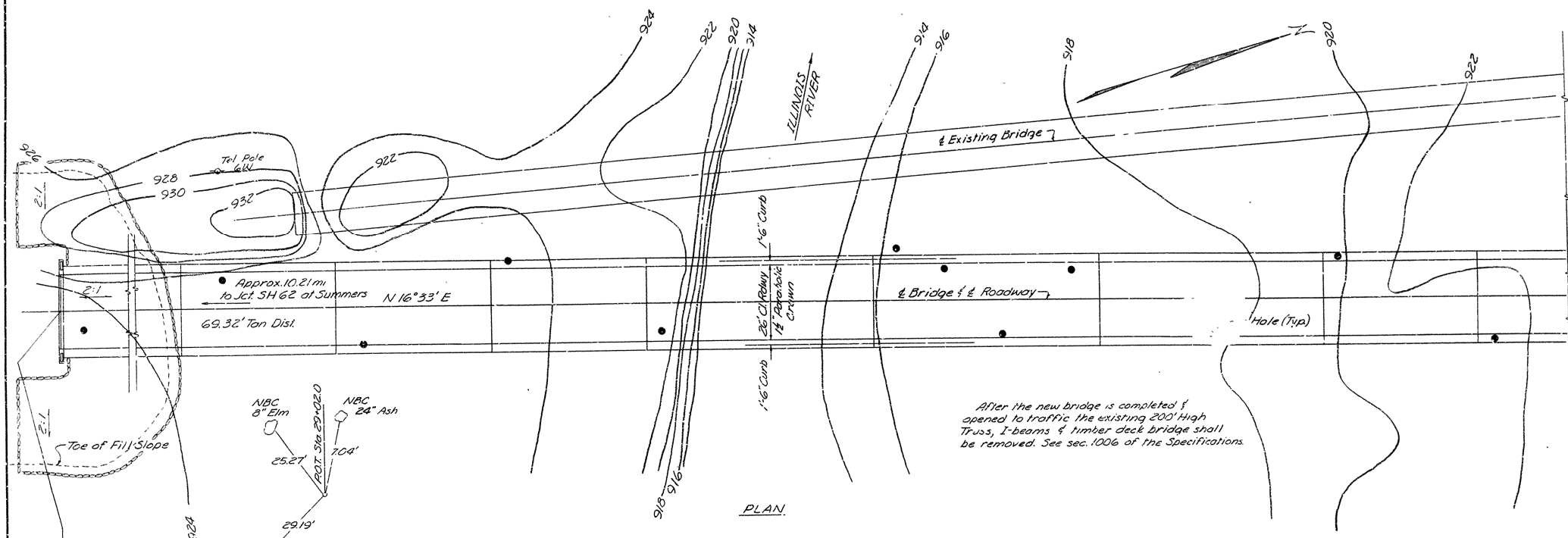
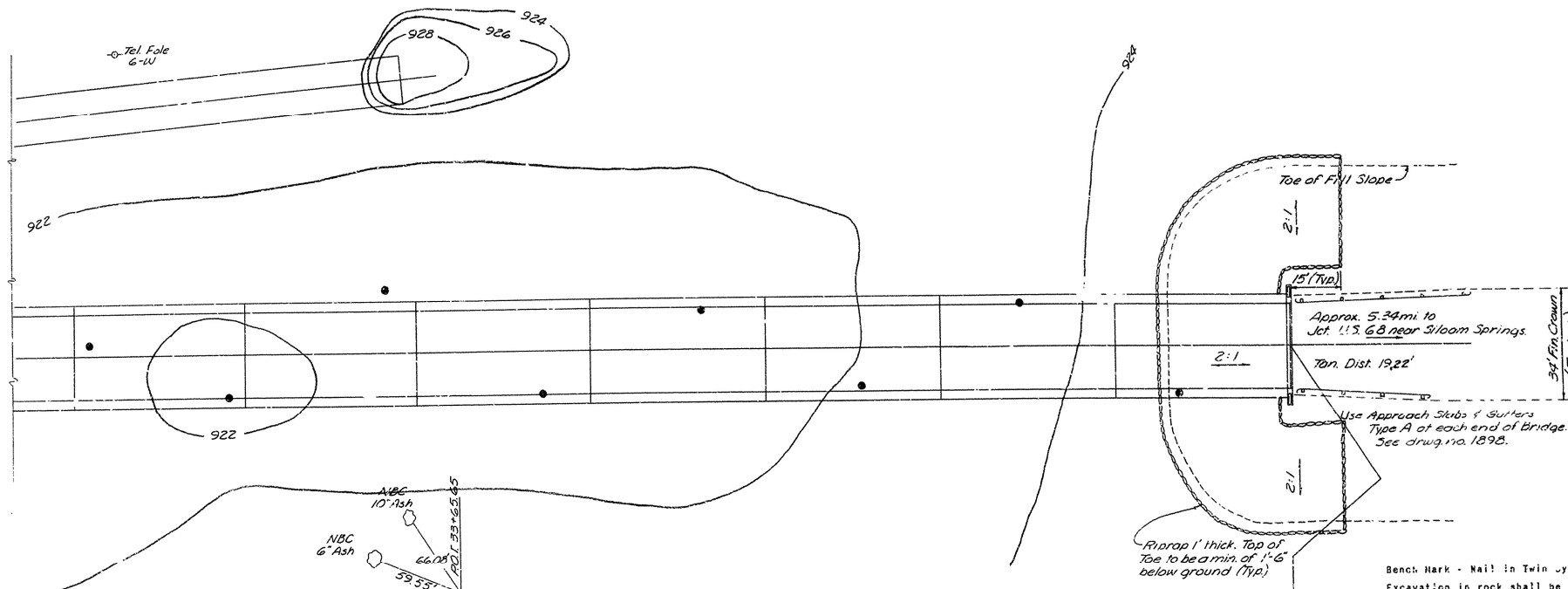

#### GENERAL NOTES

Bench Mark - Nail in Twin Lycamore 37' Rt. Sta. 24+20. Elev. 932.35. Survey Line "X".

Excavation in rock shall be made to neat lines of footings. Care shall be exercised to avoid shattering rock faces by excessive blasting.

All concrete to be poured in the dry directly against excavated surfaces of rock. All footings shall be a minimum of 2'0" into hard blue shale.

All piling shall be 12-SP-53 and shall be driven with an approved air, steam or diesel hammer to a minimum bearing capacity of 36 tons per pile and into the shale. Order lengths shown; cut-off or build-up, if necessary, to be paid for in accordance with the Standard Specifications. Piles in End Bents are to be driven after embankment is in place.

In general, all construction joints in bents or piers shall be horizontal and shall be provided with keys not less than 1 1/2" high covering the middle third of both dimensions.

For Details of Substructure see Dwg. Nos. 12231, 12232, and 15020A.

For Details of Superstructure see Dwg. Nos. 14990 and 15020.

SPECIFICATIONS: Arkansas State Highway Commission Standard Specifications for Highway Construction. Edition of 1953.

Loading:	H-20	AASHTO 1961
Stresses:		
Class A Concrete (n=15)	840 psi	
Class S Concrete (n=10)	1,200 psi	
Reinforcing Steel	20,000 psi	
Structural Steel (A36)	20,000 psi	

Foundation Pressure (DL+LL) = 2,300 p.s.f.

950  
940  
930  
920  
910  
900

#### SOIL LOG

- (a) Med. Firm Brown Sandy Clay
- (b) Firm Brown Sandy Clay Gravel & Boulders
- (c) Firm Brown Sandy Clay - Few Gravel
- (d) Clay Gravel & small Boulders Loose
- (e) Loose Gravel & small Boulders
- (f) Firm Clay Gravel & small Boulders
- (g) Hard Blue Shale

M - moist  
W - wet

Bent 4

Bent 5

Bent 6

Bent 7

Bent 8

Bent 9

Bent 10

Sta. 33+00  
Rt. 15

Sta. 34+00  
Rt. 15

Sta. 35+00  
Rt. 15

Sta. 36+00  
Rt. 15

Sta. 37+00  
Rt. 15

Sta. 38+00  
Rt. 15

Sta. 39+00  
Rt. 15

NOTE: 5-39' Piles for Bent 2-9

33+00

34+00

35+00

36+00

BRIDGE ENGINEER

BRIDGE NO. 3743 DRAWING NO. 12230

#### SHEET 2

LAYOUT OF BRIDGE OVER  
ILLINOIS RIVER  
ILLINOIS RIVER BRIDGE & APPROACHES  
BENTON COUNTY  
ROUTE 59 SEC. 2  
ARKANSAS STATE HIGHWAY COMMISSION  
LITTLE ROCK, ARK.

DRAWN BY: RWM DATE: 10-2-62  
CHECKED BY: JMM DATE: 10-2-62  
SCALE: 1"=20'