

**PLAN**

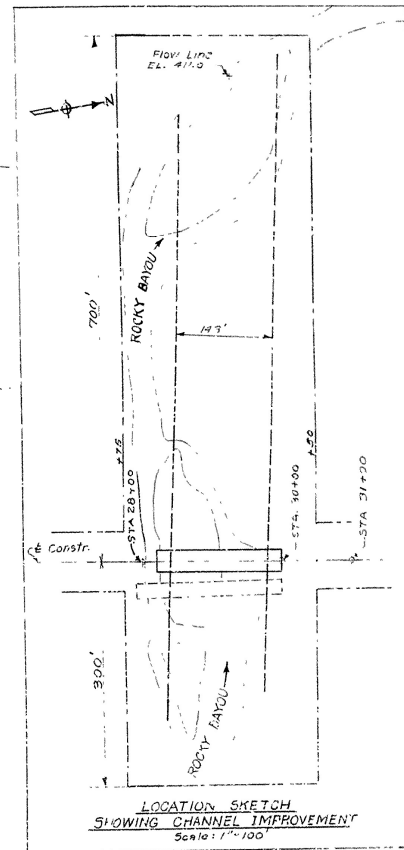

**NOTES**

B.M. Nail in 24" Sycamore 75' Lt. of Sta. 30+62 Elev. 421.63  
 For Details of Substructure see Dwg. 5350-SR  
 For Details of Superstructure see Dwg. 5350-SR

Loadings: H15 AASHO Rev. 1943  
 Stresses:  
 Reinforcing Steel 20,000  $\psi$ /in.  
 Class 'A' Concrete 340  $\psi$ /in.  
 Class 'S' Concrete 1200  $\psi$ /in.

Reinforcing: Hundred 7-25-51

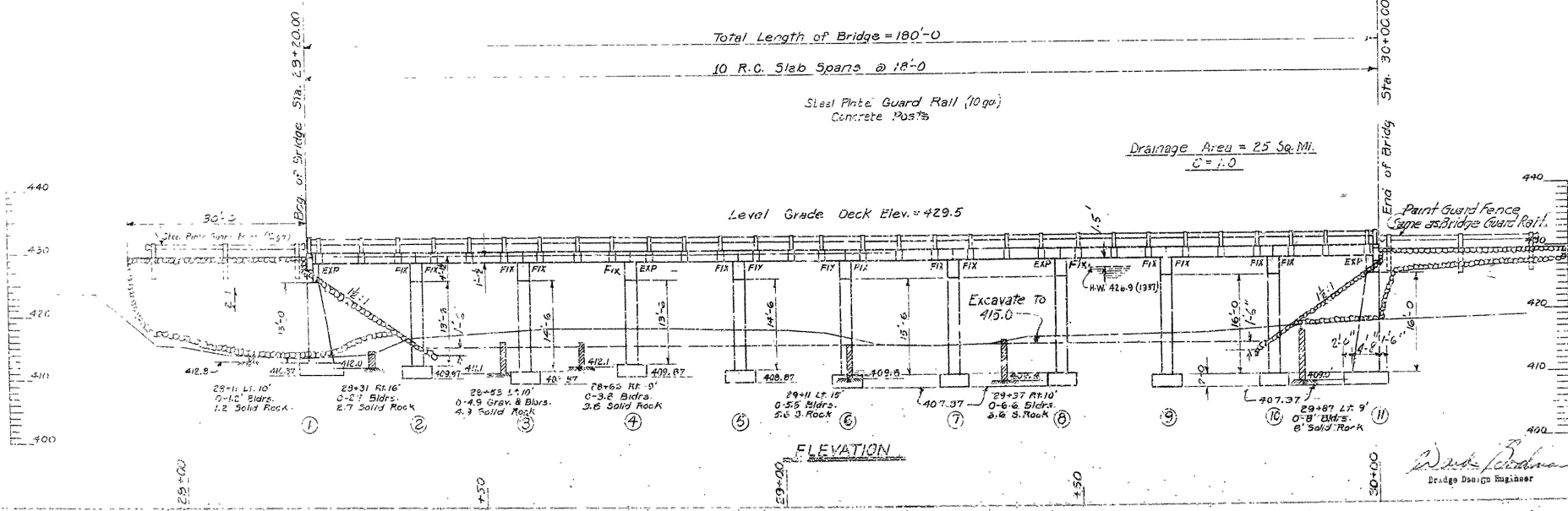

**ELEVATION**

LAYOUT OF BRIDGE  
 OVER ROCKY BAYOU  
 PLEASANT GROVE - LOCUST GROVE ROAD  
 STONE COUNTY  
 ROUTE 17 SEC. 7  
 ARKANSAS STATE HIGHWAY COMMISSION  
 LITTLE ROCK, ARK.  
 Drawn By: WMM Date: 7-9-51 Scale: 1"=10'  
 Traced By: DMM  
 Checked By: SMC Date: 7-25-51  
 BRIDGE No. 2783 DRAWING No. 8C 50

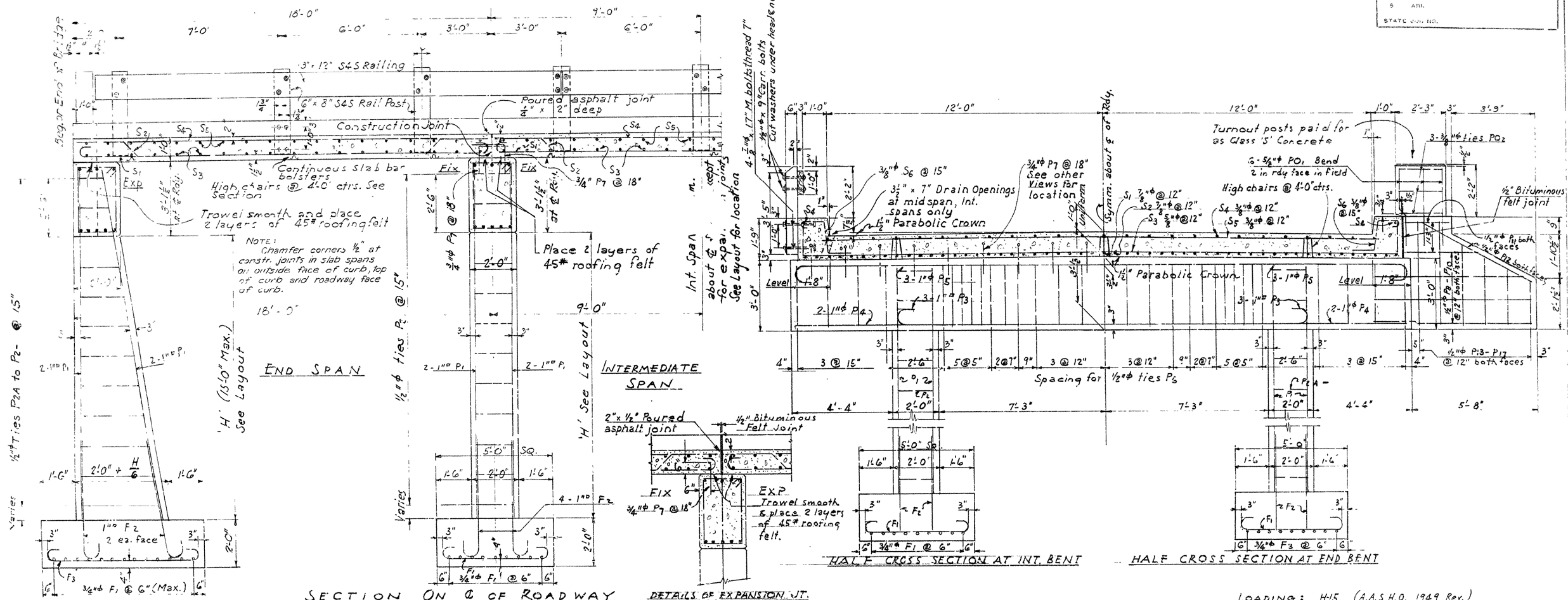

**LIST OF BENT REINFORCING BARS**

Mark	Size	Length	A	B
F <sub>1</sub>	3/4"	6'-0"	4'-6"	6"
F <sub>2</sub>	1"	6'-6"		
F <sub>3</sub>	3/4"	Varies	Varies	6"
P <sub>2</sub>	1/2"	7'-3"	1'-4"	1'-7"
P <sub>2A</sub>	1/2"	Varies	Varies	1'-7"
P <sub>3</sub>	1"	20'-0"	18'-0"	8"
F <sub>4</sub>	1/2"	9'-3"	1'-7"	2'-7"
F <sub>7</sub>	3/4"	2'-6"		
S <sub>1</sub>	7/8"	19'-2"	17'-8"	6"
S <sub>2</sub>	7/8"	18'-3"		
S <sub>3</sub>	5/8"	29'-5"		
S <sub>6</sub>	3/8"	3'-8"		
PO <sub>2</sub>	3/8"	5'-9"	2'-0"	6"

**Bending Diagram**

**LIST OF STRAIGHT BARS**

Mark	Size	Length
P <sub>1</sub>	1/2"	Varies
P <sub>4</sub>	1/2"	26'-10"
P <sub>8</sub>	1/2"	7'-2"
P <sub>9</sub>	1/2"	
P <sub>10</sub>	1/2"	
P <sub>11</sub>	1/2"	
P <sub>12</sub>	1/2"	
P <sub>13</sub>	1/2"	
P <sub>14</sub>	1/2"	
P <sub>15</sub>	1/2"	
P <sub>16</sub>	1/2"	
P <sub>17</sub>	1/2"	
S <sub>4</sub>	3/4"	15'-9"
S <sub>5</sub>	3/4"	17'-8"
P <sub>7</sub>	3/4"	26'-6"
P <sub>1</sub>	3/4"	4'-2"

**General Notes:**

Concrete in footings and columns to be Class 'A'.  
 Concrete in caps, wings and slab to be Class 'S'.  
 All exposed corners to have 3/4" chamfer unless otherwise shown.  
 Reinforcing steel to be deformed bars of intermediate grade (or see SP 303-5 when included with job). Shop lists and bending diagrams must be submitted and approved before fabrication is begun.  
 Reinforcing steel is to be held in place by steel wire supports. These are not to be raised for direct bearing but are considered subsidiary to the item "Reinforcing Steel". Shop lists of bar supports are to be submitted for approval.  
 Dimensions relating to reinforcing steel are to center of bars.  
 Bituminous felt, roofing felt & poured asphalt joints are not to be paid for directly but are to be included in price bid for "Class 'S' Concrete for Bridges".  
 Bolts, nuts & plate washers fastening rail posts to concrete curbs shall be paid for at the unit price bid for "Reinforcing Steel".  
 All timber in handrail to be untreated Southern Yellow Pine or Pacific Coast Douglas Fir.  
 Malleable or Cast Iron washers to be used under all bolt heads and nuts bearing on wood unless otherwise noted.  
 Exposed surfaces of all bolts and hardware shall be painted with red lead paint prior to construction. After construction is completed exposed surfaces of hardware in railing shall be two coats of approved white lead paint.  
 Unless otherwise specified payment for all hardware, including bolts and washers, connecting timber to timber shall be included in price bid for timber in place.  
 Unless otherwise provided, railing and posts shall be painted three coats of white lead paint.  
 Specifications: Arkansas State Highway Commission, Standard Specifications for Road and Bridge Construction, adopted March 15, 1940.

**LOADING:** H-15 (A.A.S.H.O. 1949 Rev.)  
**Unit Stresses:** (A.A.S.H.O. 1949 Rev.)  
 Class 'A' Concrete = 840 #/sq.  
 Class 'S' Concrete = 1200 #/sq.  
 Reinforcing Steel = 20000 #/sq.  
 Timber = 1600 #/sq.

**DETAILS OF STANDARD**  
**18'-0" R.C. SLAB SPANS**  
**& FRAMED R.C. BENTS**  
**24'-0" CLEAR ROADWAY, 1'-0" CURBS**

ARKANSAS STATE HIGHWAY COMMISSION  
 LITTLE ROCK, ARK.

APPROVED BY \_\_\_\_\_  
 Bridge Design Engineer

Drawn By: E.A.W. Date: 7-11-51  
 Ckd. By: G.M.C. Date: 7-16-51

Scale: 1/2" = 1'-0"

BRIDGE NO. \_\_\_\_\_ DRAWING NO. 5350