

DATE REVISED	DATE FILMED	DATE RECEIVED	DATE FILMED	FED. ROAD NO.	STATE	FED. AID NO.	FISCAL YEAR	SHEET NO.	TOTAL SHEETS
				6	ARK.	<i>U DA</i> <i>14-272</i>			
				JOB NO.		9316	28		93

(1) 14235 WIDENING 19659

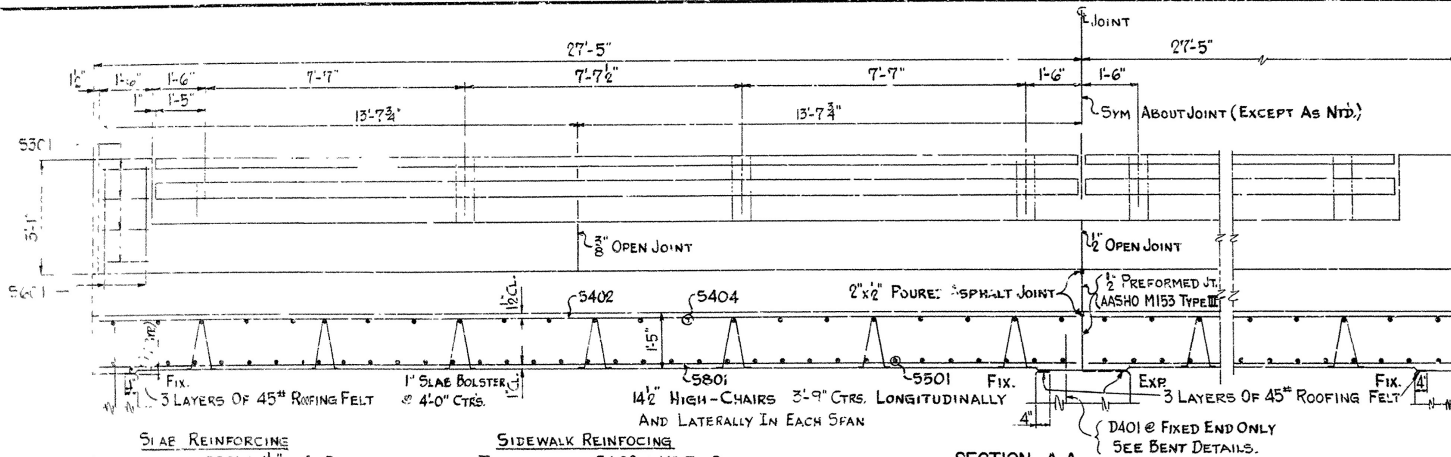

SLAB REINFORCING

LONGITUDINAL : 5801 @ 4" o.c. IN BOT.
5402 @ 15" o.c. IN TOP

TRANSVERSE : 5501 @ 9" o.c. IN BOT.
5404 @ 15" o.c. IN TOP

SIDEWALK REINFORCING
TRANSVERSE: 5602 @ 14" I.N. BOT.
5603 @ 7" I.N. TOP
LONGITUDINAL: 5402 I.N. TOP & BOT. (AS SHOWN)

SECTION A-A

NOTE EXISTING CAST IRON DRAINS
TO BE REUSED. SET 1" LOW
AND TROWEL OUT SLAB TO MEET.

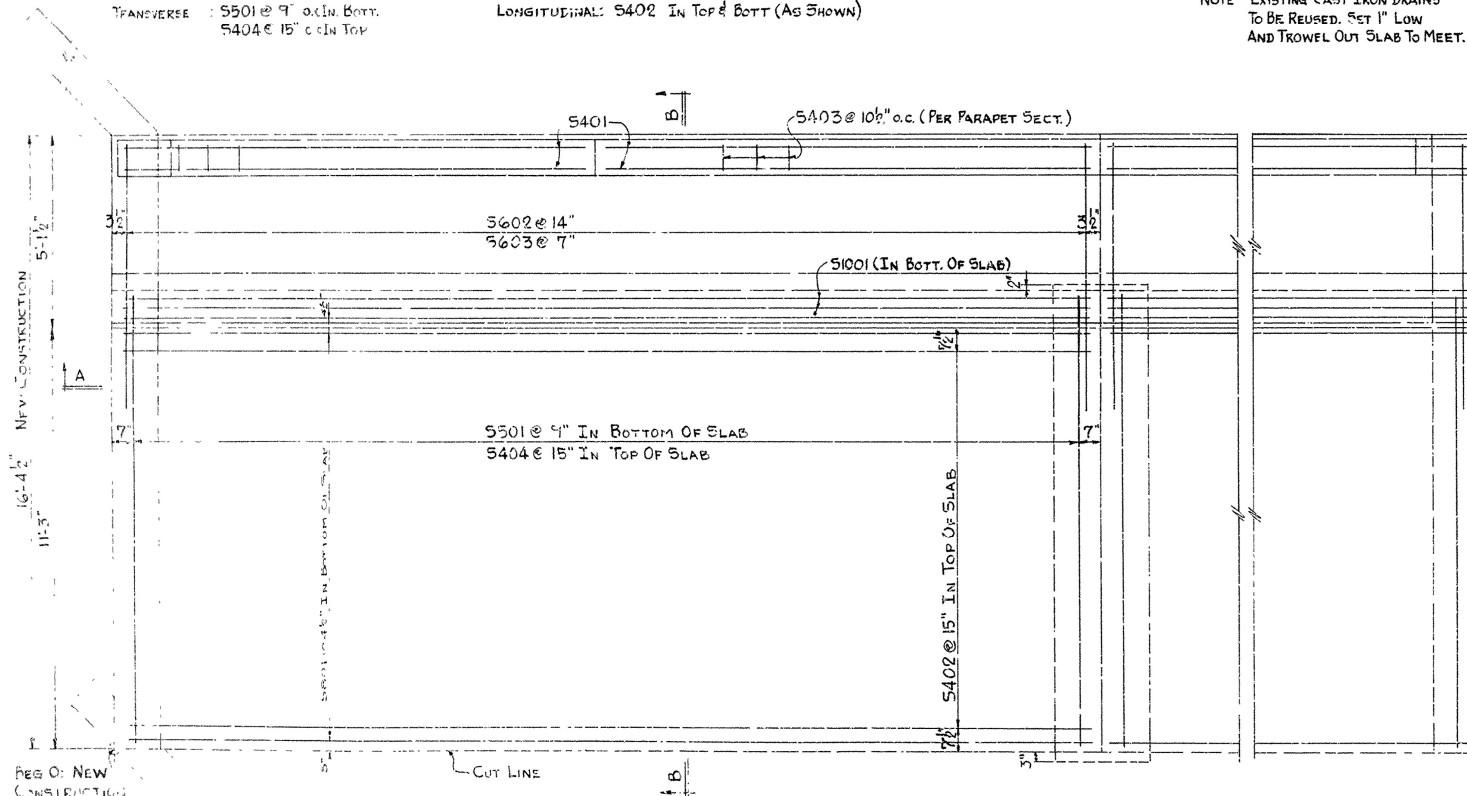

PART PLAN

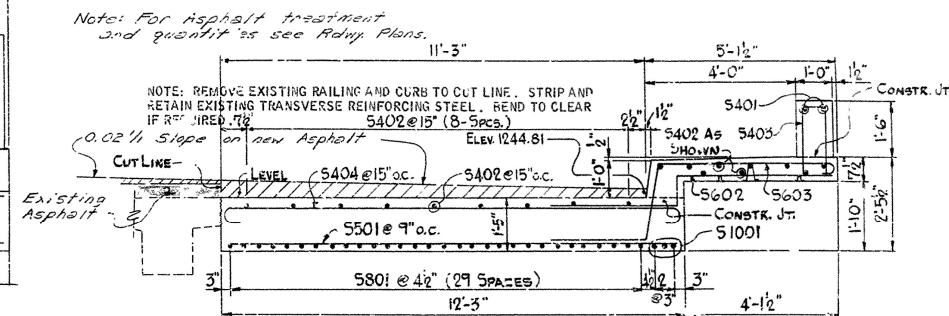

SECTION B-B

APPLY BOILED LINSEED OIL TO FRONT, BACK
& TOP OF CONCRETE PARAPET, & SIDEWALK

BAR LIST

MARK	No. REQ. CNE SPAN	LENGTH	BAR END			PIN DIA.	BENDING DIAGRAM DIMENS. ARE OUT TO OUT OF BARS
			A	B			
51001	6	27'-1"	---	---	---	STR.	
5801	60	27'-1"	---	---	---	STR.	
5601	8	3'-6"	---	---	---	STR.	
5602	48	8'-5"	4'-1 1/2"	3'-6"	3"		
5603	94	9'-10"	4'-9"	6"	3 1/2"		
5501	72	12'-0"	---	---	---	STR.	
5401	8	13'-4"	---	---	---	STR.	
5402	36	27'-1"	---	---	---	STR.	
5403	62	5'-10"	9"	1'-11"	2"		
5404	44	13'-0"	12'-0"	4"	3"		
5301	8	4'-5"	9"	1'-3"	1 1/2"		

GENERAL NOTES

THE WORK CONTEMPLATED CONSISTS OF WIDENING THE EXISTING BRIDGE ON BOTH SIDES OF THE ROADWAY. FOR REQUIREMENTS IN CONDUCTING THE WORK, SEE JOB SPECIAL PROVISION "REMODELING EXISTING BRIDGE STRUCTURE". ALL DIMENSIONS RELATING TO EXISTING BRIDGE ARE TO BE VERIFIED IN THE FIELD AND THE CONTRACTOR SHALL BE RESPONSIBLE FOR ADJUSTING WIDENING TO EXISTING STRUCTURE.

ALL CONCRETE TO BE CLASS S. ALL EXPOSED CORNERS TO HAVE 3/4" CHAMFER UNLESS OTHERWISE NOTED.

REINFORCING STEEL TO BE ASTM A615, GRADE 40. REINFORCING STEEL IS TO BE HELD IN PLACE BY MEANS OF STEEL WIRE SUPPORTS SUFFICIENT IN NUMBER AND SIZE TO PROPERLY SUPPORT THE STEEL IN THE FORMS. THESE SHOP LISTS AND BENDING DIAGRAMS OF REINFORCING STEEL AND WIRE SUPPORTS MUST BE SUBMITTED AND APPROVAL SECURED BEFORE FABRICATION IS BEGUN.

FOR DETAILS OF BRIDGE RAILING, SEE D. 14992A. BRIDGE RAILING INCLUDING END POST, RAILING POST AND FASTENINGS SHALL BE PAID FOR AT THE UNIT PRICE PER LINEAR FOOT BID FOR METAL BRIDGE RAILING.

ROOFING FELT, PREFORMED JOINT, AND POURED ASPHALT TO BE MEASURED AND PAID FOR AS CLASS S CONCRETE.

SPECIFICATIONS: ARKANSAS STATE HIGHWAY COMMISSION STANDARD SPECIFICATIONS FOR HIGHWAY CONSTRUCTION, EDITION OF 1972, *And APPLICABLE SPECIAL PROVISIONS*

DESIGN SPECIFICATIONS: AASHTO 1969
LOADING: H20
LOAD DISTRIBUTION TO SLAB:
DEAD LOAD - 248
LIVE LOAD - 0.179 WHEELS PER FT. OF WIDTH PLUS 30% IMPACT.

STRESSES	CLASS 5 CONCRETE (N=10)	1,200 PSI
	REINFORCING STEEL	20,000 PSI

SHEET NO. 1 OF 3
DETAILS OF WIDENING FOR
BRIDGE OVER BARNETT CREEK
GREENLAND-FAYETTEVILLE-LOOP
WASHINGTON COUNTY

ROUTE 71 SEC. 16

ARKANSAS STATE HIGHWAY COMMISSION

LITTLE ROCK, ARK.
7-25-44

DRAWN BY: D. S. DATE: 3-25-77 $b' = 1.3"$

TRACED BY: _____ DATE: _____ SCALE: $\frac{1}{2} = 1-0$
 CHECKED BY: LDF DATE: 2-15-72

CHECKED BY: W. J. T. DATE: 2-13-76

BRIDGE NO. 1403D DRAWING NO. 1765

BRIDGE NO. 4232 DRAWING NO. 1765

DATE REVISED	DATE FILMED	DATE REVISED	DATE FILMED	FED. ROAD NO.	STATE	FED. AID FUND.	FISCAL YEAR	SHEET NO.	TOTAL SHEETS
				6	ARK.	0192 01/3/23			
				JOB NO.		9516		27	36
① 14238 LAYOUT 17658									

GENERAL NOTES

FOOTINGS SHALL BE SET A MINIMUM OF 1'-6" INTO ROCK. ROCK EXCAVATIONS SHALL BE MADE TO NEAT LINES OF CONCRETE FOOTINGS. CARE SHALL BE EXERCISED TO AVOID SHATTERING OF ROCK FACES BY EXCESSIVE BLASTING. CONCRETE IN FOOTINGS SHALL BE POURED DIRECTLY AGAINST EXCAVATED SURFACES OF ROCK.

ALL CONCRETE SHALL BE POURED IN THE DRY.

THE CONTRACTOR SHALL MAKE CHECK MEASUREMENTS OF THE EXISTING BRIDGE AND MAKE ADJUSTMENTS NECESSARY TO FIT THE NEW WORK TO THE EXISTING STRUCTURE.

FOR DETAILS OF WIDENING ABUTMENTS AND INTERMEDIATE BENT
SEE DWG. NO. 17660, 17661
FOR DETAILS OF WIDENING SPANS, SEE DWG. NOS. 17659
FOR DETAILS OF EXISTING BRIDGE, SEE DWG. NOS. 8843 THRU 8845,
2502 THRU 2504, 1001
SPECIFICATIONS FOR MINIMUM STATE HIGHWAY COMMISSION STANDARDS

SPECIFICATIONS: ARKANSAS STATE HIGHWAY COMMISSION STANDARD
SPECIFICATIONS FOR HIGHWAY CONSTRUCTION, EDITION OF 1972,
AND APPLICABLE SPECIAL PROVISIONS.

DESIGN SPECIFICATIONS:	AASHTO	1969
LIVE LOADING:	H20	
UNIT STRESSES:	CLASS 5 CONCRETE (N=10)	1,200 PSI
	REINFORCING STEEL	20,000 PSI

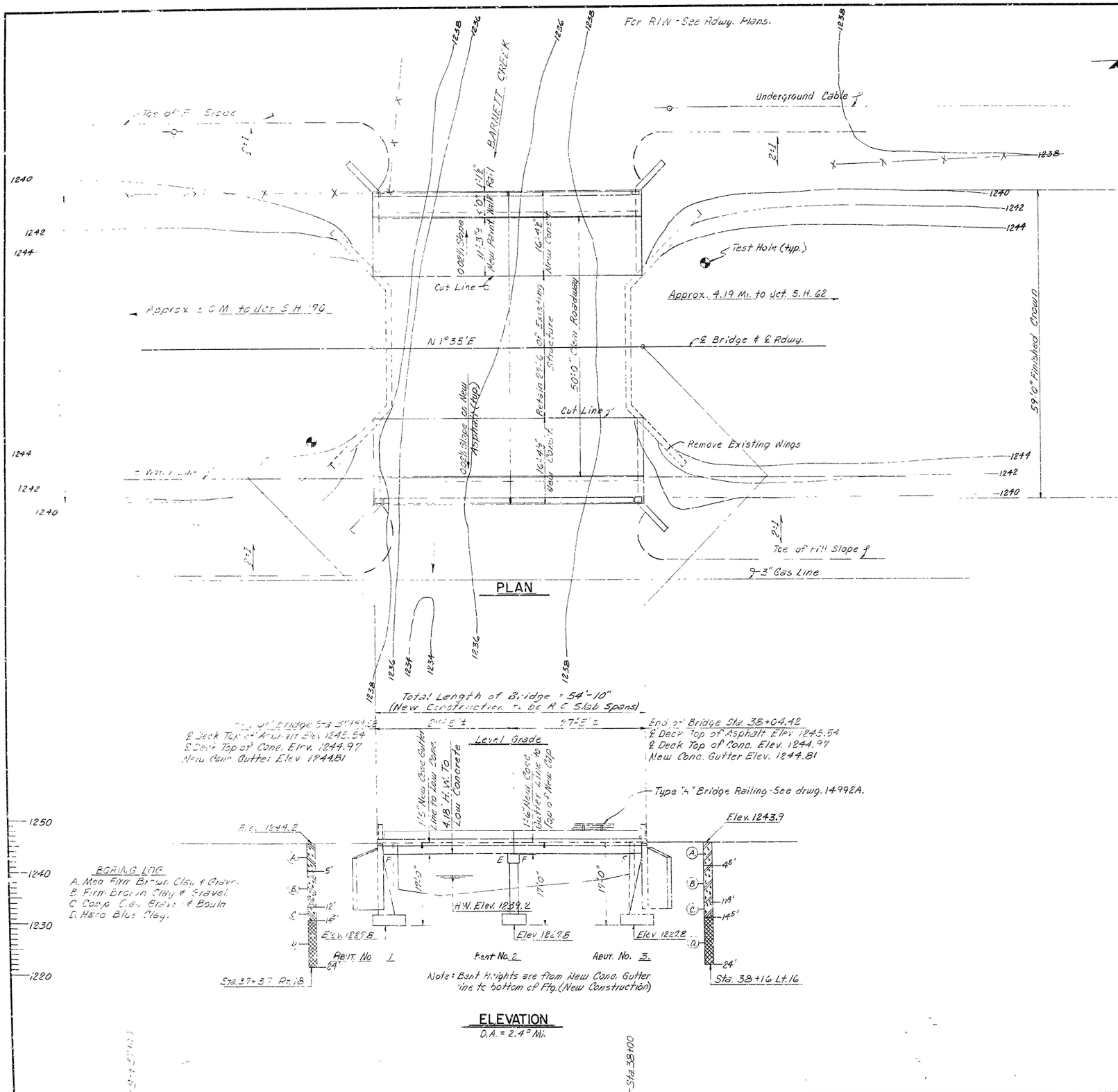

LAYOUT OF BRIDGE
OVER BARNETT CREEK
GREENLAND -
FAYETTEVILLE LOOP
WASHINGTON COUNTY

ROUTE 71 SEC. 16
ARKANSAS STATE HIGHWAY COMMISSION
LITTLE ROCK, ARK.

DRAWN BY: McBull DATE: 7-26-71
 TRACED BY: _____ DATE: _____ SCALE: 1" = 2'-0"
 CHECKED BY: WAS DATE: 7-30-71
 BRIDGE NO. 1423B DRAWING NO. 17658