

367

DATE REVISED	DATE FILMED	D/E REVISED	DATE FILMED	FED. ROAD NO.	STATE	FED. AID PROJ.	FISCAL YEAR	SHEET NO.	TOTAL SHEETS
				6	ARK.				
JOB NO.							3771	5	39
① 5526, 5527 QUANT. 18167									

SCHEDULE OF BRIDGE QUANTITIES - JOB 3771

BRIDGE NUMBER CODE	BRIDGE NUMBER	BRIDGE NAME PLATE TITLE	UNIT OF BRIDGE	ITEM NO.	213	603	801	SP # 802	803	804	SP# 805	512	816	816
				ITEM UNIT	REMOVAL OF EXISTING BRIDGE STRUCTURES	TEMPORARY BRIDGE STRUCTURES	COMMON EXCAVATION FOR STRUCTURES BRIDGE	CLASS "S" CONCRETE	BOILED LINSEED OIL	REINFORCING STEEL	PRECAST CONCRETE PILING (16" OCT)	BRIDGE NAME PLATES (TYPE C)	FILTER BLANKET	DUMPED RIP RAP
					LUMP SUM	LUMP SUM	CU. YD.	CU. YD.	GAL.	LB	LIN. FT.	EACH	CU. YD.	CU. YD.
5526 X020	MINE CREEK	END BENT 1			18	9.06		1,160	90		20	61		
		INT BENT 2			53	14.84		3,891						
		INT BENT 3			60	14.84		3,891						
		INT BENT 4			78	14.84		3,891						
		INT BENT 5			78	14.84		3,891						
		INT BENT 6			42	14.84		3,891						
		INT BENT 7			64	14.84		3,891						
		END BENT 8			18	9.06		1,160	90		17	52		
		SPANS 1 & 7				140.54	6.4	34,172		1				
		SPANS 2 - 6"				349.70	16.0	84,932						
		TOTAL FOR BRIDGE	0.85	0.85	411	591.4	26.4	144,810	180	1	37	113		
5527 X020	SANDY BRANCH	END BENT 1			16	8.99		1,126	72		49	145		
		INT. BENTS 2 & 3			118	34.81		6,763						
		END BENT 4			16	8.99		1,126	72		54	161		
		SPANS 1 & 3				100.90	4.6	18,720		1				
		SPAN 2				50.11	2.3	9,265						
		TOTAL FOR BRIDGE	0.15	0.15	150	203.8	6.9	37,000	144	1	103	309		
		TOTAL FOR JOB 3771	1.00	1.00	561	801.2	29.3	181,810	324	2	140	422		

SCHEDULE OF BRIDGE QUANTITIES
MINE CREEK & SANDY BRANCH
BRS. & APPRS.
HOWARD COUNTY
ROUTE 4 SEC. 4
ARKANSAS STATE HIGHWAY COMMISSION
LITTLE ROCK, ARK.
DRAWN BY: *H.S.* DATE: 5-7-73
TRACED BY: *W.R.* DATE: 5-9-73 SCALE: NONE
CHECKED BY: *W.R.* DATE: 5-9-73
BRIDGE NO. 5526, 5527 DRAWING NO. 18167

David L. Carter
BRIDGE ENGINEER

DATE REVISED	DATE FILMED	DATE REVISED	DATE FILMED	FED. ROAD NO.	STATE	FED. AID PROG.	FISCAL YEAR	SHEET NO.	TOTAL SHEETS
				6	ARK.			371	39
JOB NO. 5527 LAYOUT 18169									

NOTE:
EXCAVATE CHANNEL AS SHOWN WITH 2:1
SIDE SLOPES AND A BOTTOM WIDTH OF
25' @ ELEV. 344.0 APPROX. 100' L.
YDS. OF CHANNEL EXCAVATION.

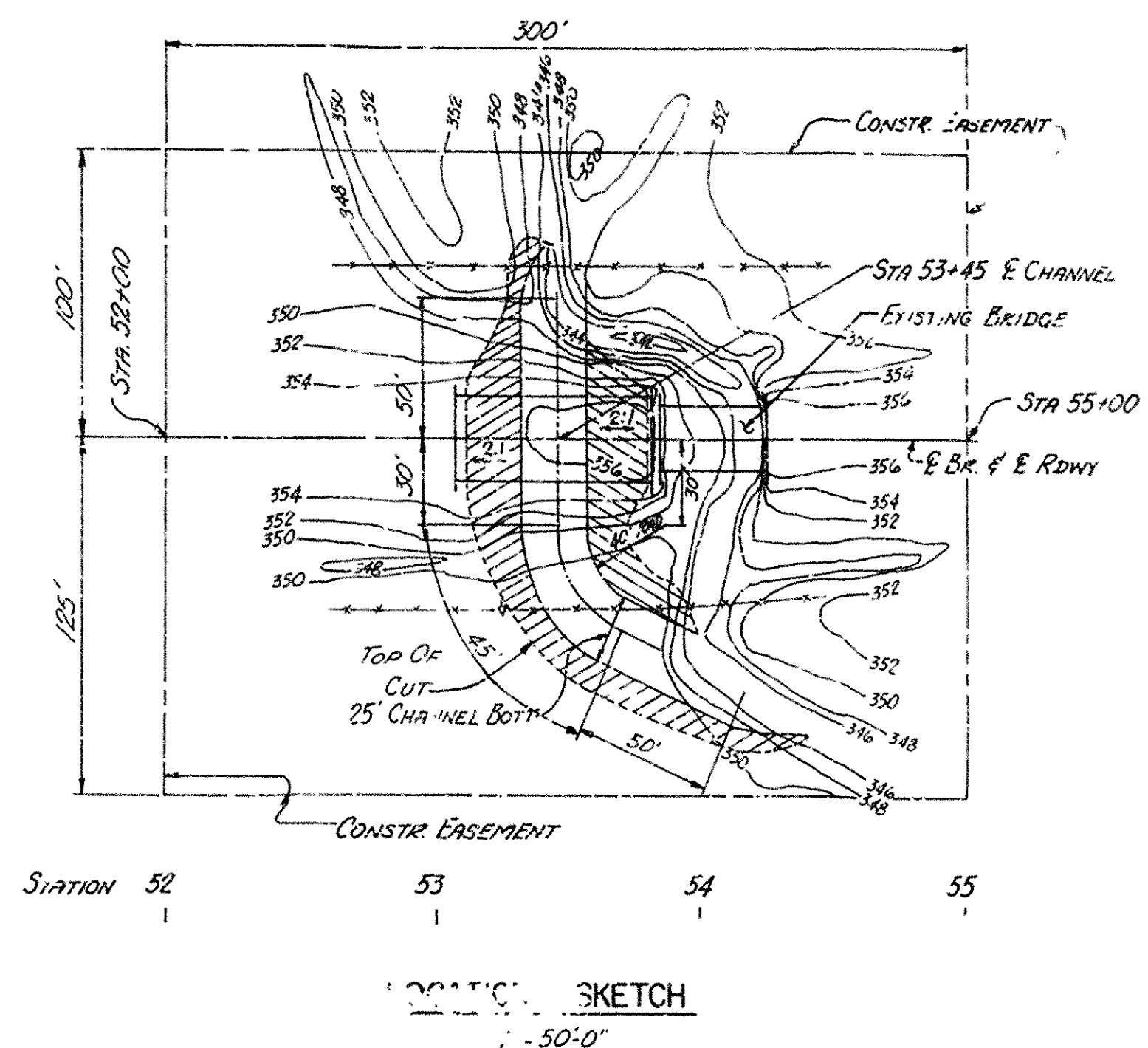

GENERAL NOTES

BENCH MARK - SQUARE CUT ON NORTH EAST CORNER OF WEST HEADWALL 10' RT. STA. 53+84, ELEV. 356.63.

ALL CONCRETE TO BE POURED IN THE DRY.

ALL PILING SHALL BE 16" OCTAGONAL PRECAST CONCRETE AND SHALL BE DRIVEN WITH AN APPROVED AIR, STEAM, OR DIESEL HAMMER TO A MINIMUM BEARING CAPACITY OF 44 TONS PER PILE, AND TO A MINIMUM PENETRATION OF 20 FEET BELOW THE GROUND LINE. LENGTHS OF PILING SHOWN ARE ASSUMED FOR ESTIMATING QUANTITIES ONLY. ACTUAL LENGTHS TO BE DETERMINED IN THE FIELD. DRIVE ONE 23' TEST PILE IN BENT NO. 1.

FOOTINGS SHALL BE LOCATED A MINIMUM OF 2'-0" INTO FIRM GRAY SANDY CLAY AND GRAVEL. TOPS OF FOOTINGS SHALL BE LOCATED A MINIMUM OF 4'-0" BELOW THE BOTTOM OF THE CHANNEL. SEE ARTICLE 801.04 OF SECTION 801 OF THE STANDARD SPECIFICATIONS FOR PREPARATION OF FOUNDATION FOR FOOTINGS.

PILES IN END BENTS TO BE DRIVEN AFTER EMBANKMENT TO SURGRADE IS IN PLACE.

FOR DETAILS OF END BENTS, SEE DWG. NO. 14854.
FOR DETAILS OF INTERMEDIATE BENTS, SEE DWG. NO. 18171.
FOR DETAILS OF PRECAST CONCRETE PILING, SEE DWG. NO. 2382.
FOR DETAILS OF SUPERSTRUCTURE, SEE DWG. NO. 14853.

SPECIFICATIONS: ARKANSAS STATE HIGHWAY COMMISSION STANDARD SPECIFICATIONS FOR HIGHWAY CONSTRUCTION, EDITION OF 1972, AND APPLICABLE SPECIAL PROVISIONS.

DESIGN SPECIFICATIONS: AASHO 1969

LIVE LOADING: HS-20

UNIT STRESSES: CLASS 5 CONCRETE (N=10) 1,200 PSI
REINFORCING STEEL 20,000 PSI

LAYOUT OF BRIDGE OVER
SANDY BRANCH
MINE CREEK & SANDY BRANCH
BRS. & APPRS.
HOWARD COUNTY
ROUTE 4 SEC. 4

ARKANSAS STATE HIGHWAY COMMISSION
LITTLE ROCK, ARK.

DRAWN BY: *[Signature]* DATE: 3-27-73
TRACED BY: DATE: 3-27-73
CHECKED BY: DATE: 3-27-73
SCALE: 1"=10'-0" OR AS SHD.
BRIDGE NO. 5527 DRAWING NO. 18169

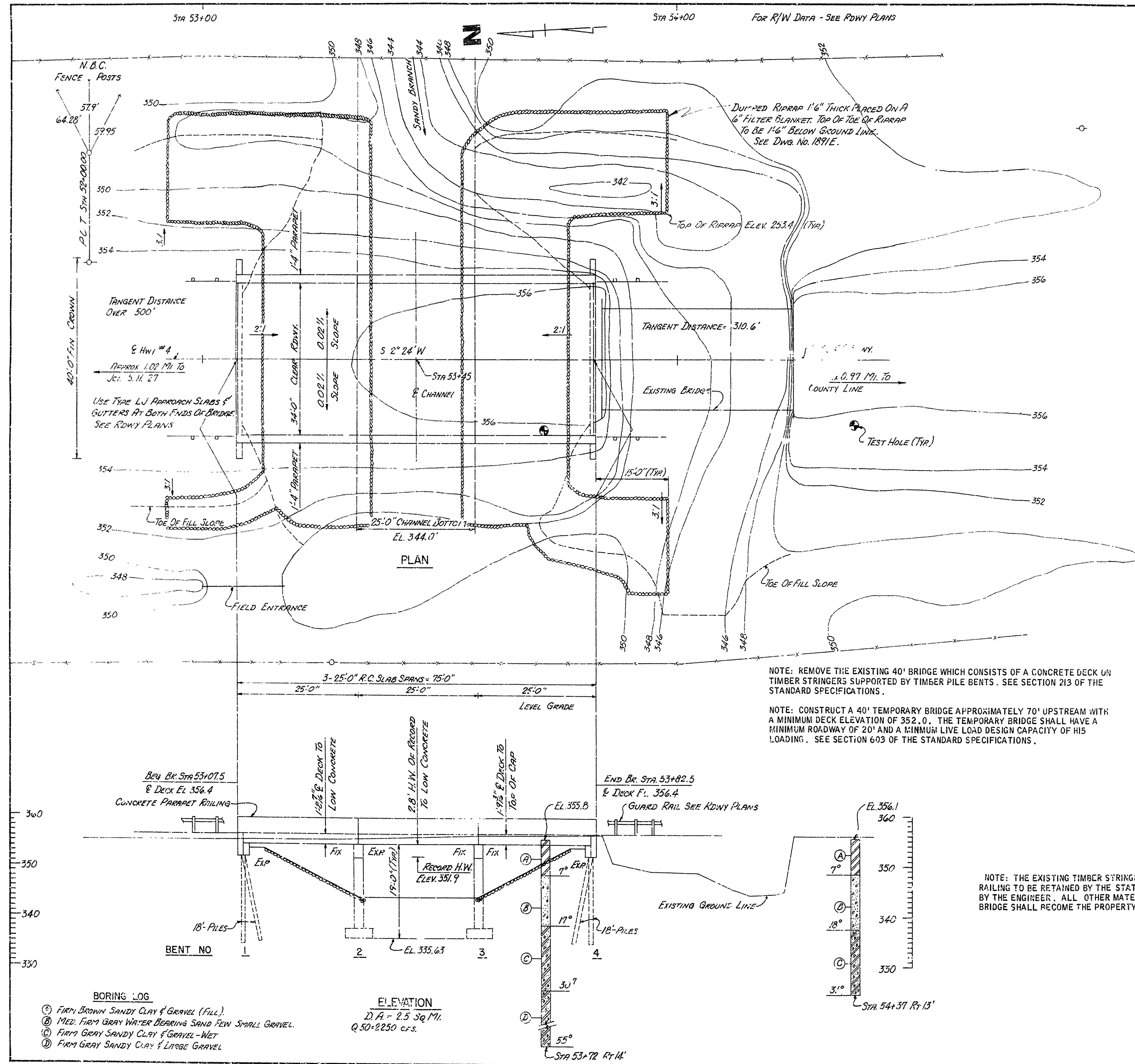

NOTE: REMOVE THE EXISTING 40' BRIDGE WHICH CONSISTS OF A CONCRETE DECK ON TIMBER STRINGERS SUPPORTED BY TIMBER PILE BENTS. SEE SECTION 213 OF THE STANDARD SPECIFICATIONS.

NOTE: CONSTRUCT A 40' TEMPORARY BRIDGE APPROXIMATELY 70' UPSTREAM WITH A MINIMUM DECK ELEVATION OF 352.0. THE TEMPORARY BRIDGE SHALL HAVE A MINIMUM ROADWAY OF 20' AND A MINIMUM LIVE LOAD DESIGN CAPACITY OF HIS LOADING. SEE SECTION 603 OF THE STANDARD SPECIFICATIONS.

NOTE: THE EXISTING TIMBER STRINGERS AND STEEL PLATE RAILING TO BE RETAINED BY THE STATE SHALL BE DETERMINED BY THE ENGINEER. ALL OTHER MATERIAL FROM THE EXISTING BRIDGE SHALL BECOME THE PROPERTY OF THE CONTRACTOR.

- BORING LOG
- ① FIRM BROWN SANDY CLAY & GRAVEL (FILL).
 - ② MED. FIRM GRAY WATER BEARING SAND FEW SMALL GRAVEL.
 - ③ FIRM GRAY SANDY CLAY & GRAVEL - WET
 - ④ FIRM GRAY SANDY CLAY & LARGE GRAVEL

ELEVATION
D.A. = 2.5 Sq. Mi.
Q. 50=2250 c.f.s.

