

DATE REVISED	DATE REVISED	FED. RD. DIST. NO.	STATE	JOB NO.	SHEET NO.	TOTAL SHEETS
05/20/2026		6	ARK.	101189	21	44
SUMMARY OF QUANTITIES AND REVISIONS						

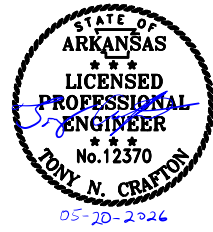

SUMMARY OF QUANTITIES

ITEM NUMBER	ITEM	QUANTITY	UNIT
201	CLEARING	2	STATION
201	GRUBBING	2	STATION
202	REMOVAL AND DISPOSAL OF PIPE CULVERTS	6	EACH
SP, SS, & 210	UNCLASSIFIED EXCAVATION	1030	CU. YD.
SP & 210	COMPACTED EMBANKMENT	707	CU. YD.
SP & 210	SOIL STABILIZATION	20	TON
SP, SS, & 303	AGGREGATE BASE COURSE (CLASS 7)	2771	TON
SS & 401	TACK COAT	1830	GAL.
SP, SS, & 406	MINERAL AGGREGATE IN ACHM BINDER COURSE (1")	440	TON
SP, SS, & 406	ASPHALT BINDER (PG 70-22) IN ACHM BINDER COURSE (1")	21	TON
SP, SS, & 407	MINERAL AGGREGATE IN ACHM SURFACE COURSE (1/2")	1692	TON
SP, SS, & 407	ASPHALT BINDER (PG 64-22) IN ACHM SURFACE COURSE (1/2")	3	TON
SP, SS, & 407	ASPHALT BINDER (PG 70-22) IN ACHM SURFACE COURSE (1/2")	99	TON
SP & 412	COLD MILLING ASPHALT PAVEMENT	2433	SQ. YD.
SP, SS, & 414	ASPHALT CONCRETE PATCHING FOR MAINTENANCE OF TRAFFIC	7	TON
SP, SS, & 415	ACHM PATCHING OF EXISTING ROADWAY	10	TON
SP, SS, & 505	PORTLAND CEMENT CONCRETE DRIVEWAY	107.67	SQ. YD.
601	MOBILIZATION	1.00	LUMP SUM
SP & 602	FURNISHING FIELD OFFICE	1	EACH
SS & 603	MAINTENANCE OF TRAFFIC	1.00	LUMP SUM
SS & 604	SIGNS	533	SQ. FT.
SS & 604	BARRICADES	64	LIN. FT.
SS & 604	TRAFFIC DRUMS	49	EACH
604	CONSTRUCTION PAVEMENT MARKINGS	6325	LIN. FT.
604	REMOVAL OF CONSTRUCTION PAVEMENT MARKINGS	3296	LIN. FT.
604	REMOVAL OF PERMANENT PAVEMENT MARKINGS	3300	LIN. FT.
SS & 604	VERTICAL PANELS	27	EACH
SS & 606	36" REINFORCED CONCRETE PIPE CULVERTS (CLASS III)	28	LIN. FT.
SS & 606	36" FLARED END SECTIONS FOR REINFORCED CONCRETE PIPE CULVERTS	3	EACH
SP, SS, & 606	18" SIDE DRAIN	32	LIN. FT.
SP, SS, & 606	24" SIDE DRAIN	148	LIN. FT.
SS & 606	SELECTED PIPE BEDDING	20	CU. YD.
SS & 611	4" PIPE UNDERDRAINS	500	LIN. FT.
SS & 611	UNDERDRAIN OUTLET PROTECTORS	4	EACH
620	LIME	4	TON
620	SEEDING	2.10	ACRE
SS & 620	MULCH COVER	4.80	ACRE
620	WATER	269.8	M. GAL.
621	TEMPORARY SEEDING	2.70	ACRE
621	SAND BAG DITCH CHECKS	308	BAG
621	SEDIMENT REMOVAL AND DISPOSAL	24	CU. YD.
621	ROCK DITCH CHECKS	30	CU. YD.
623	SECOND SEEDING APPLICATION	2.10	ACRE
624	SOLID SODDING	51	SQ. YD.
635	ROADWAY CONSTRUCTION CONTROL	1.00	LUMP SUM
642	RUMBLE STRIPS IN ASPHALT SHOULDERS	987	LIN. FT.
SP & 701	ACTUATED CONTROLLER TS2-TYPE 2 (8 PHASES)	1	EACH
SP	FLASHING BEACON ASSEMBLY	2	EACH
SP & 706	TRAFFIC SIGNAL HEAD, LED, (3 SECTION, 1 WAY)	11	EACH
SP & 706	TRAFFIC SIGNAL HEAD, LED, (4 SECTION, 1 WAY)	4	EACH
708	TRAFFIC SIGNAL CABLE (5C/14 A.W.G.)	2757	LIN. FT.
708	TRAFFIC SIGNAL CABLE (7C/14 A.W.G.)	369	LIN. FT.
708	TRAFFIC SIGNAL CABLE (20C/14 A.W.G.)	672	LIN. FT.
SP	ELECTRICAL CONDUCTORS-IN-CONDUIT (1C/8 A.W.G., E.G.C.)	2217	LIN. FT.
SP	ELECTRICAL CONDUCTORS-IN-CONDUIT (1C/12 A.W.G., E.G.C.)	264	LIN. FT.
SP	ELECTRICAL CONDUCTORS-IN-CONDUIT (2C/6 A.W.G.)	27	LIN. FT.
SP	ELECTRICAL CONDUCTORS FOR LUMINAIRES	996	LIN. FT.
709	GALVANIZED STEEL CONDUIT (2")	20	LIN. FT.
710	NON-METALLIC CONDUIT (2")	1621	LIN. FT.
710	NON-METALLIC CONDUIT (3")	516	LIN. FT.
SS & 711	CONCRETE PULL BOX (TYPE 1 HD)	4	EACH
SS & 711	CONCRETE PULL BOX (TYPE 2 HD)	6	EACH
SS & 714	TRAFFIC SIGNAL MAST ARM AND POLE WITH FOUNDATION (62')	2	EACH
SS & 714	TRAFFIC SIGNAL MAST ARM AND POLE WITH FOUNDATION (64')	1	EACH
SS & 714	TRAFFIC SIGNAL MAST ARM AND POLE WITH FOUNDATION (66')	1	EACH
SP	LED LUMINAIRE ASSEMBLY	4	EACH
SP	SERVICE POINT ASSEMBLY (2 CIRCUITS)	1	EACH
719	THERMOPLASTIC PAVEMENT MARKING WHITE (6")	3788	LIN. FT.
719	THERMOPLASTIC PAVEMENT MARKING WHITE (24")	134	LIN. FT.
719	THERMOPLASTIC PAVEMENT MARKING YELLOW (6")	3506	LIN. FT.
719	THERMOPLASTIC PAVEMENT MARKING (WORDS)	4	EACH
719	THERMOPLASTIC PAVEMENT MARKING (ARROWS)	4	EACH
721	RAISED PAVEMENT MARKERS (TYPE II)	81	EACH
SP	18" STREET NAME SIGN	6	EACH
SP & 733	HYBRID VIDEO/RADAR DETECTOR	4	EACH
SP & 733	VIDEO CABLE (EXTERIOR CAT 5E)	1067	LIN. FT.
SP & 733	VIDEO MONITOR (CLR)	1	EACH
SP & 733	CENTRAL CONTROL UNIT (8 CHANNEL)	1	EACH

REVISIONS

DATE	REVISION	SHEET NUMBER
5/20/2026	REVISED "TRAFFIC SIGNAL HEAD, LED, (3 SECTION, 1 WAY)", "TRAFFIC SIGNAL HEAD, LED, (4 SECTION, 1 WAY)", "TRAFFIC SIGNAL CABLE (5C/14 A.W.G.)", AND "TRAFFIC SIGNAL CABLE (7C/14 A.W.G.)" QUANTITIES.	21, 27, 32, 36, 37

SUMMARY OF QUANTITIES AND REVISIONS

DATE REVISED	DATE REVISED	FED. RD. DIST. NO.	STATE	JOB NO.	SHEET NO.	TOTAL SHEETS
05/20/2026		6	ARK.	101189	27	44
SUMMARY OF TRAFFIC SIGNAL QUANTITIES						

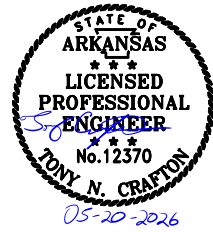

SUMMARY OF TRAFFIC SIGNAL QUANTITIES

ITEM NUMBER	ITEM	QUANTITY	UNIT
SP & 701	ACTUATED CONTROLLER TS2-TYPE 2 (8 PHASES)	1	EACH
SP	FLASHING BEACON ASSEMBLY	2	EACH
SP & 706	TRAFFIC SIGNAL HEAD, LED, (3 SECTION, 1 WAY)	11	EACH
SP & 706	TRAFFIC SIGNAL HEAD, LED, (4 SECTION, 1 WAY)	4	EACH
708	TRAFFIC SIGNAL CABLE (5C/14 A.W.G.)	2757	LIN. FT.
708	TRAFFIC SIGNAL CABLE (7C/14 A.W.G.)	369	LIN. FT.
708	TRAFFIC SIGNAL CABLE (20C/14 A.W.G.)	672	LIN. FT.
SP	ELECTRICAL CONDUCTORS-IN-CONDUIT (1C/8 A.W.G., E.G.C.)	2217	LIN. FT.
SP	ELECTRICAL CONDUCTORS-IN-CONDUIT (1C/12 A.W.G., E.G.C.)	264	LIN. FT.
SP	ELECTRICAL CONDUCTORS-IN-CONDUIT (2C/6 A.W.G.)	27	LIN. FT.
SP	ELECTRICAL CONDUCTORS FOR LUMINAIRES	996	LIN. FT.
709	GALVANIZED STEEL CONDUIT (2")	20	LIN. FT.
710	NON-METALLIC CONDUIT (2")	1621	LIN. FT.
710	NON-METALLIC CONDUIT (3")	516	LIN. FT.
SS & 711	CONCRETE PULL BOX (TYPE 1 HD)	4	EACH
SS & 711	CONCRETE PULL BOX (TYPE 2 HD)	6	EACH
SS & 714	TRAFFIC SIGNAL MAST ARM AND POLE WITH FOUNDATION (62')	2	EACH
SS & 714	TRAFFIC SIGNAL MAST ARM AND POLE WITH FOUNDATION (64')	1	EACH
SS & 714	TRAFFIC SIGNAL MAST ARM AND POLE WITH FOUNDATION (66')	1	EACH
SP	LED LUMINAIRE ASSEMBLY	4	EACH
SP	SERVICE POINT ASSEMBLY (2 CIRCUITS)	1	EACH
SP	18" STREET NAME SIGN	6	EACH
SP & 733	HYBRID VIDEO/RADAR DETECTOR	4	EACH
SP & 733	VIDEO CABLE (EXTERIOR CAT 5E)	1067	LIN. FT.
SP & 733	VIDEO MONITOR (CLR)	1	EACH
SP & 733	CENTRAL CONTROL UNIT (8 CHANNEL)	1	EACH

R101189-17-5G-PSG-000A.DGN    SAVED: 5/20/2026

PHASING DIAGRAM

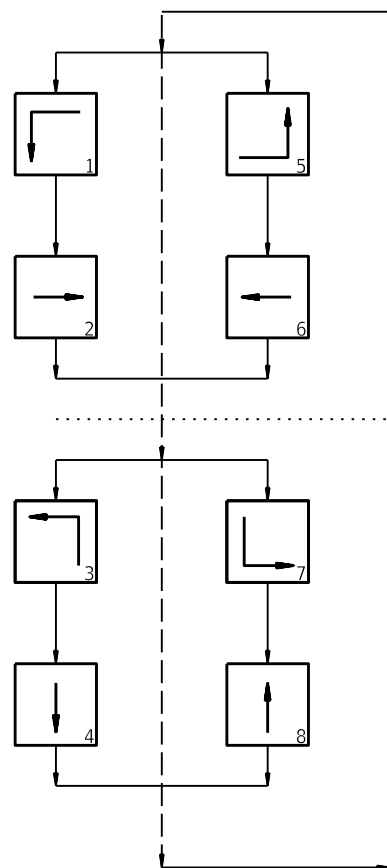

SIGNAL FACES

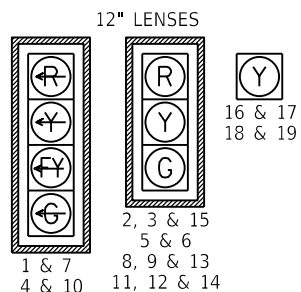

NOTES:

1. ALL SIGNAL HEADS SHALL HAVE BACKPLATES.
2. REFER TO SPECIAL PROVISION "RETROREFLECTIVE BACKPLATES" FOR DETAILS ON REQUIREMENTS FOR BACKPLATES.

DATE REVISED	DATE REVISED	FED. RD. DIST. NO.	STATE	JOB NO.	SHEET NO.	TOTAL SHEETS
05/20/2026		6	ARK.	101189	32	44

SIGNALIZATION PLAN SHEETS

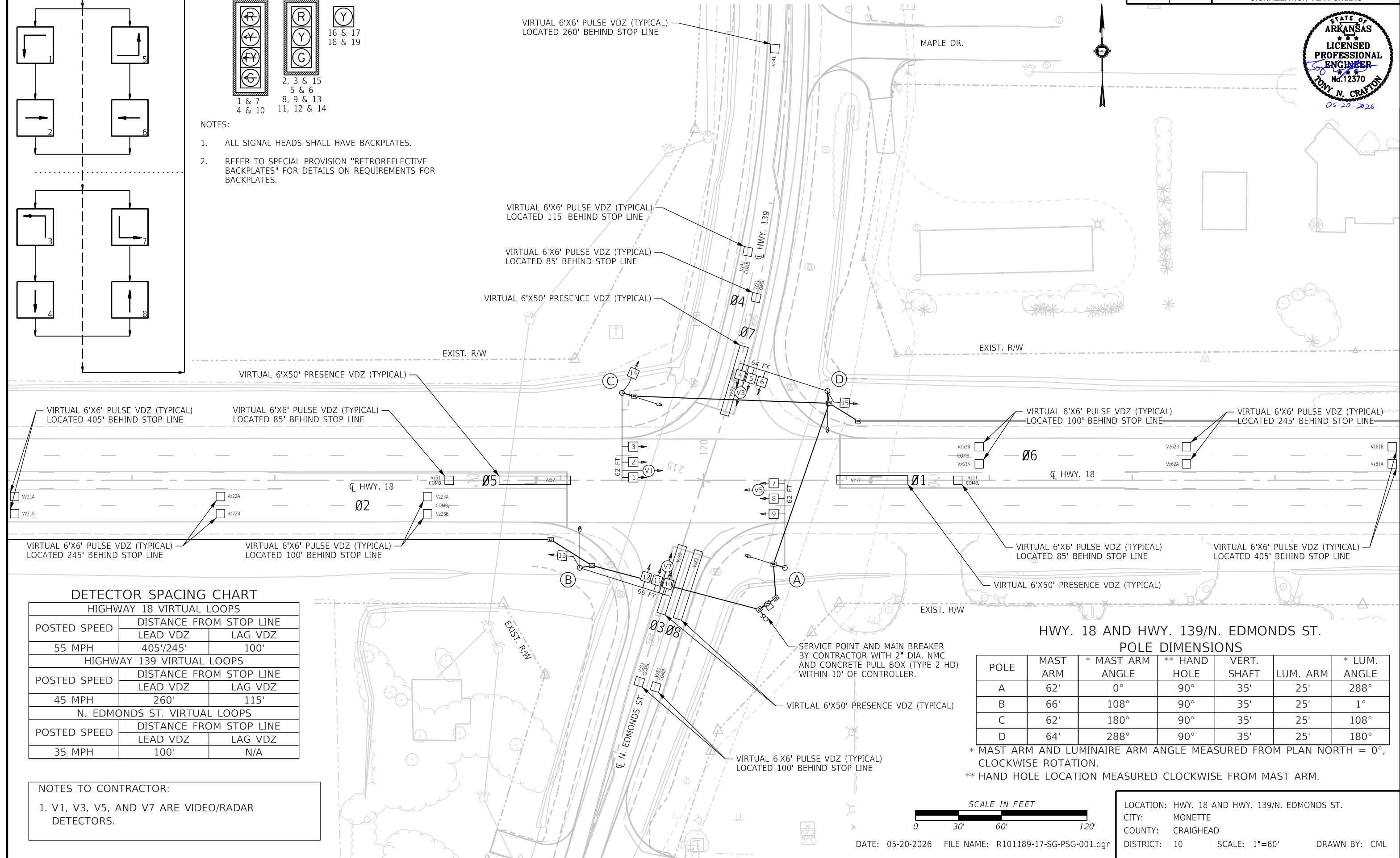
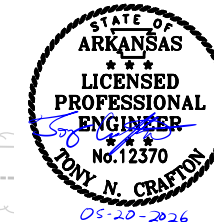

DETECTOR SPACING CHART

HIGHWAY 18 VIRTUAL LOOPS		
POSTED SPEED	DISTANCE FROM STOP LINE	
	LEAD VDZ	LAG VDZ
55 MPH	405'/245'	100'
HIGHWAY 139 VIRTUAL LOOPS		
POSTED SPEED	DISTANCE FROM STOP LINE	
	LEAD VDZ	LAG VDZ
45 MPH	260'	115'
N. EDMONDS ST. VIRTUAL LOOPS		
POSTED SPEED	DISTANCE FROM STOP LINE	
	LEAD VDZ	LAG VDZ
35 MPH	100'	N/A

NOTES TO CONTRACTOR:

1. V1, V3, V5, AND V7 ARE VIDEO/RADAR DETECTORS.

HWY. 18 AND HWY. 139/N. EDMONDS ST. POLE DIMENSIONS

POLE	MAST ARM	* MAST ARM ANGLE	** HAND HOLE	VERT. SHAFT	LUM. ARM	* LUM. ANGLE
A	62'	0°	90°	35'	25'	288°
B	66'	108°	90°	35'	25'	1°
C	62'	180°	90°	35'	25'	108°
D	64'	288°	90°	35'	25'	180°

\* MAST ARM AND LUMINAIRE ARM ANGLE MEASURED FROM PLAN NORTH = 0°, CLOCKWISE ROTATION.  
 \*\* HAND HOLE LOCATION MEASURED CLOCKWISE FROM MAST ARM.



DATE: 05-20-2026 FILE NAME: R101189-17-SG-PSG-001.dgn

LOCATION: HWY. 18 AND HWY. 139/N. EDMONDS ST.  
 CITY: MONETTE  
 COUNTY: CRAIGHEAD  
 DISTRICT: 10 SCALE: 1"=60' DRAWN BY: CML

R101189-17-SG-PSG-001.DGN SAVED: 5/20/2026

DATE REVISED	DATE REVISED	FED. RD. DIST. NO.	STATE	JOB NO.	SHEET NO.	TOTAL SHEETS
05/20/2026		6	ARK.	101189	36	44
SIGNALIZATION PLAN SHEETS						

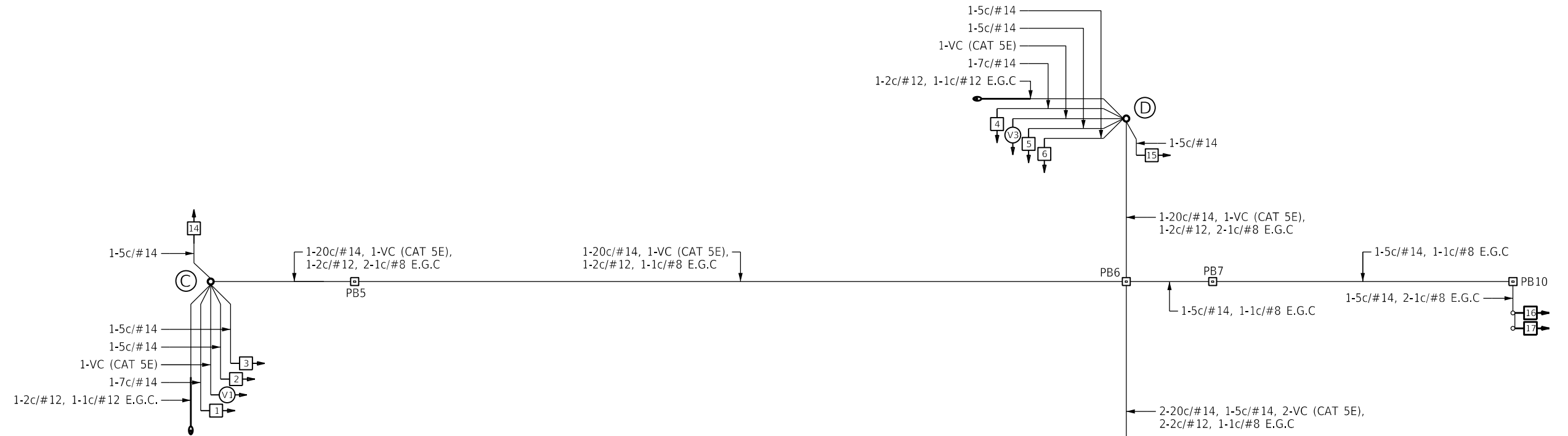
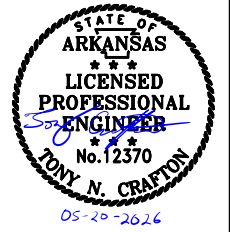

**WIRING DIAGRAM**

- NOTES TO CONTRACTOR:
1. ALL DETECTOR RACK CHANNELS, INCLUDING UNUSED, SHALL BE BROUGHT TO TERMINAL STRIP IN DETECTOR AREA OF CABINET.
  2. THE LOCAL GOVERNMENT SHALL BE RESPONSIBLE FOR PROVIDING POWER TO THE SERVICE POINT.
  3. SEE SHEET NUMBER 28 FOR GROUNDING ARRAY DETAIL.

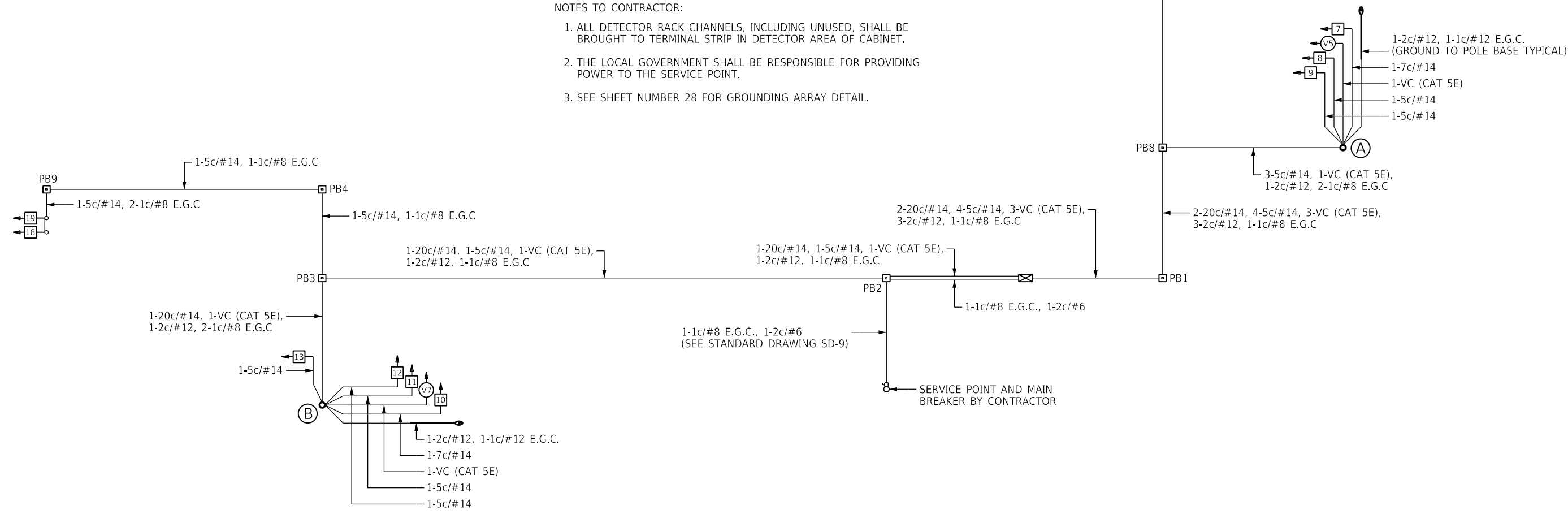

LOCATION: HWY. 18 AND HWY. 139/N. EDMONDS ST.  
 CITY: MONETTE  
 COUNTY: CRAIGHEAD  
 DISTRICT: 10 SCALE: N/A DRAWN BY: CML

DATE: 05-20-2026 FILE NAME: R101189-17-SG-PSG-004.dgn

R101189-17-SG-PSG-004.DGN SAVED: 5/20/2026



### TRAFFIC FLOW DIAGRAM

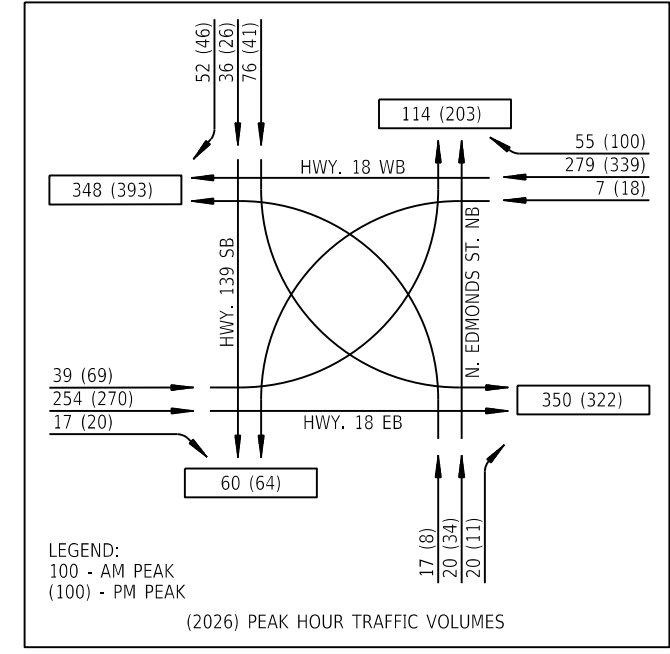

### PHASING DIAGRAM

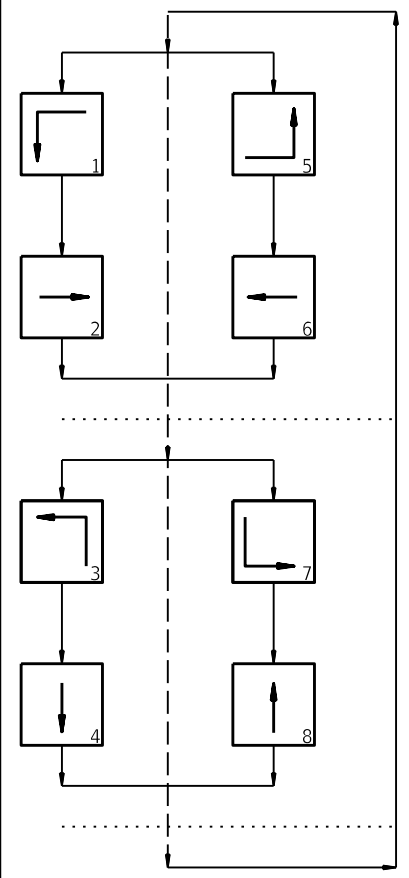

### SIGNAL FACES

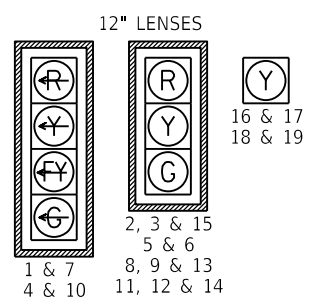

NOTES:

- ALL SIGNAL HEADS SHALL HAVE BACKPLATES.
- REFER TO SPECIAL PROVISION "RETROREFLECTIVE BACKPLATES" FOR DETAILS ON REQUIREMENTS FOR BACKPLATES.

### DETECTOR CHART

DETECTOR SYSTEM DESCRIPTION: JOB 101189												
HWY. 18 AND HWY. 139/N. EDMONDS ST. DETECTOR ASSIGNMENTS				HARDWARE INPUTS BY SUPPLIER			PROGRAM ASSIGNMENTS			COMMENTS	TUBE LENGTHS	
DET. ID #	LOCATION DIRECTION	TYPE	DET. #	CAB. TRM.	AMP CHN.	CON. IMP. #	PHS	SYSTEM DET. #	LOCAL			MASTER SYSTEM DETECTOR NUMBERS
Vz11	WB LEFT TURN FAR	COMB.				V9	1	1			CAMERA V1	MAST ARM
Vz12	WB LEFT TURN	LOCAL				V1	1				CAMERA V1	MOUNTED
Vz21 A&B	EB ADVANCE	LOCAL				V2	2				CAMERA V5	MAST ARM
Vz22 A&B	EB INTERMEDIATE	LOCAL				V2	2				CAMERA V5	MAST ARM
Vz23 A&B	EB NEAR	COMB.				V10	2	2			CAMERA V5	MOUNTED
Vz31	NB LEFT TURN FAR	COMB.				V11	3	3			CAMERA V3	MAST ARM
Vz32	NB LEFT TURN	LOCAL				V3	3				CAMERA V3	MOUNTED
Vz41	SB ADVANCE	LOCAL				V4	4				CAMERA V7	MAST ARM
Vz42	SB NEAR	COMB.				V12	4	4			CAMERA V7	MOUNTED
Vz51	EB LEFT TURN FAR	COMB.				V13	5	5			CAMERA V5	MAST ARM
Vz52	EB LEFT TURN	LOCAL				V5	5				CAMERA V5	MOUNTED
Vz61 A&B	WB ADVANCE	LOCAL				V6	6				CAMERA V1	MAST ARM
Vz62 A&B	WB INTERMEDIATE	LOCAL				V6	6				CAMERA V1	MAST ARM
Vz63 A&B	WB NEAR	COMB.				V14	6	6			CAMERA V1	MOUNTED
Vz71	SB LEFT TURN FAR	COMB.				V15	7	7			CAMERA V7	MAST ARM
Vz72	SB LEFT TURN	LOCAL				V7	7				CAMERA V7	MOUNTED
Vz81	NB ADVANCE	COMB.				V16	8	8			CAMERA V3	MAST ARM
Vz82	NB NEAR	LOCAL				V8	8				CAMERA V3	MOUNTED
SPARE:												

CONTROLLER INPUT ABBREVIATIONS:  
V = VEHICLE INPUT  
D = SYSTEM OR AUXILIARY INPUT  
P = PEDESTRIAN INPUT

NOTE: THIS IS WIRED TO CONTROLLER INPUT DETECTOR NUMBER WHICH IS PROGRAMMED TO ACTUATE THE DESIGNATED PHASE.  
EXAMPLE: V9 = SYSTEM DETECTOR 1, V10 = SYSTEM DETECTOR 2

### INTERVAL CHART

SIGNAL FACES	HWY. 18 AND HWY. 139/N. EDMONDS ST.															FLASH SEQUENCE	
	1+5	CLR.	1+6	CLR.	2+5	CLR.	2+6	CLR.	3+7	CLR.	3+8	CLR.	4+7	CLR.	4+8		CLR.
1	←G	*	←G	*	←FY	***	←FY	***	←R	←R	←R	←R	←R	←R	←R	←R	←R
2, 3, & 15	R	R	G	**	R	R	G	**	R	R	R	R	R	R	R	R	R
4	←R	←R	←R	←R	←R	←R	←R	←R	←G	*	←G	*	←FY	***	←FY	***	←R
5 & 6	R	R	R	R	R	R	R	R	R	R	G	**	R	R	G	**	R
7	←G	*	←FY	***	←G	*	←FY	***	←R	←R	←R	←R	←R	←R	←R	←R	←R
8, 9, & 13	R	R	R	R	G	**	G	**	R	R	R	R	R	R	R	R	R
10	←R	←R	←R	←R	←R	←R	←R	←R	←G	*	←FY	***	←G	*	←FY	***	←R
11, 12, & 14	R	R	R	R	R	R	R	R	R	R	R	R	G	**	G	**	R
16 & 17	FY	FY	FY	FY	FY	FY	FY	FY	FY	FY	FY	FY	FY	FY	FY	FY	FY
18 & 19	FY	FY	FY	FY	FY	FY	FY	FY	FY	FY	FY	FY	FY	FY	FY	FY	FY

\* DENOTES GREEN OR YELLOW ARROW DEPENDING ON NEXT PHASE  
\*\* DENOTES GREEN OR YELLOW BALL DEPENDING ON NEXT PHASE  
\*\*\* DENOTES FLASHING YELLOW ARROW OR YELLOW ARROW DEPENDING ON NEXT PHASE

R101189-17-SG-PSG-005.DGN SAVED: 5/20/2026

LOCATION: HWY. 18 AND HWY. 139/N. EDMONDS ST.  
CITY: MONETTE  
COUNTY: CRAIGHEAD  
DISTRICT: 10 SCALE: N/A DRAWN BY: CML