

TIER 3 CATEGORICAL EXCLUSION

**ARDOT JOB NUMBER 100955
FAP NUMBER NHPP-CHBP-0047(81)
HWYS. 77, 140,158, & 181 STRS. & APPRS. (MISSISSIPPI CO.) (S)
VARIOUS ROUTES AND SECTIONS
MISSISSIPPI COUNTY**

Submitted Pursuant to 42 U.S.C. 4332(2)

By the

U.S. Department of Transportation

Federal Highway Administration

And the

Arkansas Department of Transportation

October 2020

October 29, 2020
Date of Approval

Randal Looney
Randal Looney
Environmental Coordinator
Federal Highway Administration

The Environmental Division reviewed the referenced project and determined it falls within the definition of the Tier 3 Categorical Exclusion (CE) as defined by the ARDOT/FHWA Programmatic Agreement on the processing of CEs. The following information is included for your review and, if acceptable, approval as the environmental documentation for this project.

The purpose of this project is to replace multiple bridge and culvert structures on Hwys. 77, 140, 158, and 181 west of Osceola in Mississippi County. One box culvert (Str. #X0345) and two bridges (Strs. #03781 and #03782) on Hwy. 140 and an unnamed drainage structure on Hwy. 181 were previously addressed under Job Number 100996 in a Tier 3 CE approved in August 2019. One bridge on Hwy. 158 (Str. #M2094) was previously addressed under Job Number 100999 in a Tier 2 CE approved in May 2019. The sites previously addressed under Job Numbers 100996 and 100999 have since been incorporated under Job Number 100955. This CE only covers the structures not included in previous CEs.

The combined total length of the project is approximately 2.35 miles. A project location map is attached.

Existing bridge information is as follows:

Hwy.	Str. #	Str. Length x Width (ft)	Poor Condition Rating / Posting Required?
77	02138	54.0 x 26.5	Y / N
	02873	122.0 x 28.8	Y / Y
	02881	362.0 x 28.5	N / Y
	02872	202.0 x 28.7	Y / Y
	02871	322.0 x 28.7	Y / Y
	02870	202.0 x 28.5	Y / N
	02141	144.0 x 26.6	Y / N
158	M4039	232.0 x 31.0	Y / Y
181	M2231	44.0 x 25.0	Y / Y
	M2232	45.0 x 25.2	Y / Y

Existing roadway information is as follows:

Hwy. 77 has two 10' wide paved travel lanes with 4' wide unpaved shoulders at Str. #02138 and 4' wide (2' paved) shoulders at the other structure replacement locations. Existing right of way width ranges from 80' to 140'.

Hwy. 158 has two 10' wide paved travel lanes with 5' wide unpaved shoulders. Where established, existing right of way width is 90'.

Hwy. 181 has two 10' wide paved travel lanes with 3' wide paved shoulders. Where established, existing right of way width is 90'.

Proposed roadway information is as follows:

Hwy. 77 will have two 11' wide paved travel lanes with 4' (2' paved) wide shoulders. The average proposed right of way width will range from 140' to 170'. Str. #02138 will be replaced with a box culvert; the remaining structures will be replaced with bridges.

Hwy. 158 will have two 11' wide paved travel lanes with 4' (2' paved) wide shoulders. The average proposed right of way width will range from 140' to 200'. Str. #M4039 will be replaced with a bridge.

Hwy. 181 will have two 11' wide paved travel lanes with 4' wide paved shoulders. The average proposed right of way width will range from 80' to 245'. Strs. #M2231 and #M2232 will be replaced with reinforced concrete box culverts.

A combined total of approximately 20.3 acres of new right of way will be acquired for this project.

Design data for this project are as follows:

Hwy. No.	Design Year	Average Daily Traffic	Percent Trucks	Design Speed (mph)
77	2021	1,900	6	55
	2041	2,300		
158	2021	550	3	60
	2041	600		
181	2021	950	7	60
	2041	1,000		

There are no anticipated relocations or impacts to environmental justice populations, underground storage tanks/hazardous wastes, wetlands, or cultural resources associated with this project. State Historic Preservation Officer clearance is attached. Approximately 7.0 acres of Prime Farmland will be converted to highway right of way; Form NRCS-CPA-106 is attached.

Based on the ARDOT noise policy, a noise analysis is not required for this project. Replacing the structures will not involve adding capacity, substantially changing the roadway alignment, or exposing noise sensitive land uses to traffic noise sources. In compliance with federal guidelines, local authorities will not require notification.

This project has been determined to generate minimal air quality impacts for Clean Air Act criteria pollutants and has not been linked with any special mobile source air toxic (MSAT) concerns. As such, this project will not result in changes in traffic volumes, vehicle mix, basic project location, or any other factor that would cause a meaningful increase in MSAT impacts of the project from that of the no-build alternative.

Mississippi County participates in the National Flood Insurance Program. With one exception (Str. #02138), six of the seven Hwy. 77 bridge replacement locations are located in Special Flood Hazard Area Zone A. The final project design will be reviewed to confirm that the design is adequate and that the potential risk to life and property are minimized. Adjacent properties should not be impacted nor have a greater flood risk than existed before project construction. None of the encroachments will constitute a significant floodplain encroachment or a significant risk to property or life.

The attached official species list obtained from the US Fish and Wildlife Service's (USFWS) Information for Planning and Consultation website identified the following federally listed species as potentially occurring in the project area: Eastern Black Rail (*Laterallus jamaicensis ssp. jamaicensis*); Piping Plover (*Charadrius melodus*); Red Knot (*Calidris canutus rufa*); Fat Pocketbook (*Potamilus capax*); and Scaleshell Mussel (*Leptodea leptodon*).

Based on the lack of habitat and distance to known occurrences of species, it has been determined that the proposed project will have "no effect" on Eastern Black Rail, Piping Plover, Red Knot, and Scaleshell Mussel. Based on the limited habitat being affected, negative results from the mussel survey, highly disturbed environment, and distance to known species occurrences, it has been determined that the proposed project "may affect, but is not likely to adversely affect" the Fat Pocketbook. The USFWS concurrence is attached.

Impacts to Waters of the United States will be less than 0.1 acre per stream crossing. Construction should be allowed under the terms of a Nationwide Permit 14 for Linear Transportation Crossings as defined in the Federal Register 82 (4): 1860 – 2008.

A Virtual Public Involvement Meeting will be held in November 2020.

No other environmental impacts were identified. The checklist used to verify consideration of potential environmental impacts is attached.

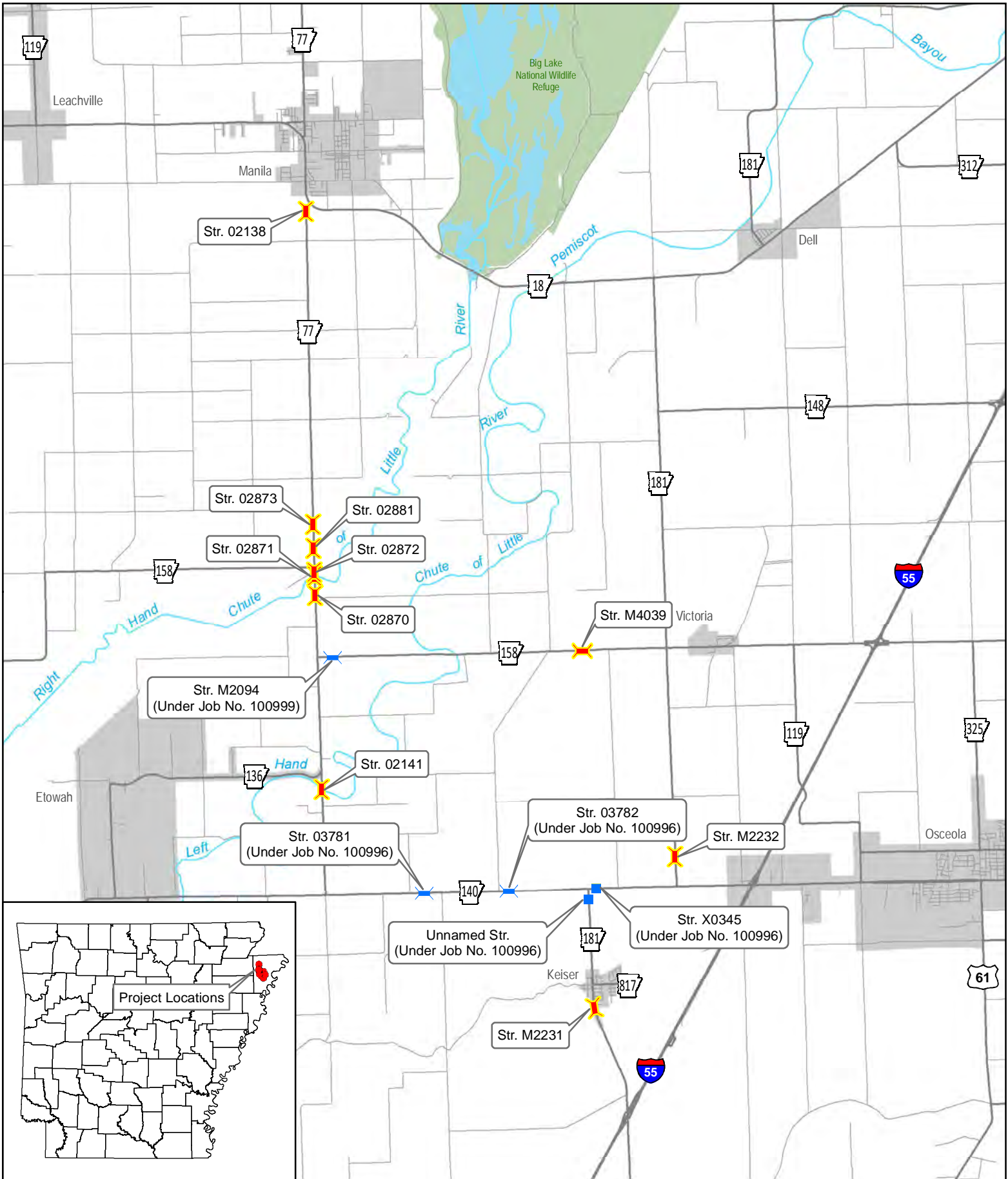

Job 100955
 Hwys. 77, 140, 158, & 181
 Str. & Apprs.
 (Various Hwys.)
 Mississippi County

-  Project Location - Bridge Previously Approved
-  Project Location - Bridge
-  Project Location - Box

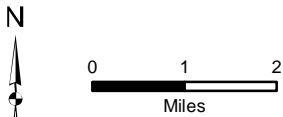

Brown, Caitlin M.

From: Eric Mills <Eric.Mills@arkansas.gov>
Sent: Friday, October 23, 2020 11:23 AM
To: Environmental Clearance
Cc: Looney, Randal
Subject: 105610.01 / ARDOT 100955 / Mississippi County

CAUTION: This email originated from outside of ARDOT. Do not click links or open attachments unless you recognize the sender and know the content is safe.

October 23, 2020

Mr. John Fleming
Division Head
Environmental Division
Arkansas Department of Transportation
P.O. Box 2261
Little Rock, AR 72203-2261

RE: Mississippi County — General
Section 106 Review — FHWA
Proposed Undertaking — Bridge Replacement
Hwys 77, 140, 158, & 181
Strs. & Apprs.
(Mississippi Co.) (S)
Routes 77, 140, 158, 181
Section 2, 2, 1, 1, 1&2
AHPP Tracking Number 105610.01

Dear Mr. Fleming:

The staff of the Arkansas Historic Preservation Program (AHPP) reviewed the Project Identification Form (PIF) for the proposed undertaking in Mississippi County, Arkansas. As described, the undertaking entails replacing fourteen bridges: 02138, 02141, 02870, 02871, 02872, 02873, 02881, 03781, 03782, XO345, M2094, M2231, M2232, and M4039. The AHPP previously concurred that all fourteen bridges are not eligible for inclusion in the National Register (AHPP Tracking Numbers 101684, 102975.01, 103657.01, and 105610). ***Please note the AHPP previously assigned the incorrect tracking number of 105619 to 105610 due to a transcription error.*** The area of potential effects includes 30.4 acres of proposed right-of-way and 3.2 acres of temporary construction easement.

Based on the provided information and the negative results of the field investigation, the AHPP concurs with a finding of **no historic properties affected pursuant to 36 CFR 800.4(d)(1)** for the proposed undertaking.

Thank you for the thorough documentation and the opportunity to review this undertaking and PIF. Please contact me if you have any questions or comments.

Sincerely,

Eric

ERIC R. MILLS
Archeologist / Section 106 Manager

Arkansas Historic Preservation Program
1100 North Street
Little Rock, AR 72201
eric.mills@arkansas.gov
p: 501.324.9784 | f: 501.324.9184

ArkansasPreservation.com



**FARMLAND CONVERSION IMPACT RATING
FOR CORRIDOR TYPE PROJECTS**

PART I (To be completed by Federal Agency) Job 100955	3. Date of Land Evaluation Request	4. Sheet 1 of _____
--	------------------------------------	---------------------

1. Name of Project	5. Federal Agency Involved
--------------------	----------------------------

2. Type of Project	6. County and State
--------------------	---------------------

PART II (To be completed by NRCS)	1. Date Request Received by NRCS	2. Person Completing Form
--	----------------------------------	---------------------------

3. Does the corridor contain prime, unique statewide or local important farmland? (If no, the FPPA does not apply - Do not complete additional parts of this form). YES <input type="checkbox"/> NO <input type="checkbox"/>	4. Acres Irrigated Average Farm Size
---	--

5. Major Crop(s)	6. Farmable Land in Government Jurisdiction Acres: _____ % _____	7. Amount of Farmland As Defined in FPPA Acres: _____ % _____
------------------	---	--

8. Name Of Land Evaluation System Used	9. Name of Local Site Assessment System	10. Date Land Evaluation Returned by NRCS
--	---	---

PART III (To be completed by Federal Agency)	Alternative Corridor For Segment			
---	---	--	--	--

	Corridor A	Corridor B	Corridor C	Corridor D
--	------------	------------	------------	------------

A. Total Acres To Be Converted Directly				
---	--	--	--	--

B. Total Acres To Be Converted Indirectly, Or To Receive Services				
---	--	--	--	--

C. Total Acres In Corridor				
----------------------------	--	--	--	--

PART IV (To be completed by NRCS) Land Evaluation Information				
--	--	--	--	--

A. Total Acres Prime And Unique Farmland				
--	--	--	--	--

B. Total Acres Statewide And Local Important Farmland				
---	--	--	--	--

C. Percentage Of Farmland in County Or Local Govt. Unit To Be Converted				
---	--	--	--	--

D. Percentage Of Farmland in Govt. Jurisdiction With Same Or Higher Relative Value				
--	--	--	--	--

PART V (To be completed by NRCS) Land Evaluation Information Criterion Relative value of Farmland to Be Serviced or Converted (Scale of 0 - 100 Points)				
--	--	--	--	--

PART VI (To be completed by Federal Agency) Corridor Assessment Criteria (These criteria are explained in 7 CFR 658.5(c))	Maximum Points			
--	-----------------------	--	--	--

1. Area in Nonurban Use	15			
-------------------------	----	--	--	--

2. Perimeter in Nonurban Use	10			
------------------------------	----	--	--	--

3. Percent Of Corridor Being Farmed	20			
-------------------------------------	----	--	--	--

4. Protection Provided By State And Local Government	20			
--	----	--	--	--

5. Size of Present Farm Unit Compared To Average	10			
--	----	--	--	--

6. Creation Of Nonfarmable Farmland	25			
-------------------------------------	----	--	--	--

7. Availability Of Farm Support Services	5			
--	---	--	--	--

8. On-Farm Investments	20			
------------------------	----	--	--	--

9. Effects Of Conversion On Farm Support Services	25			
---	----	--	--	--

10. Compatibility With Existing Agricultural Use	10			
--	----	--	--	--

TOTAL CORRIDOR ASSESSMENT POINTS	160			
----------------------------------	-----	--	--	--

PART VII (To be completed by Federal Agency)				
---	--	--	--	--

Relative Value Of Farmland (From Part V)	100			
--	-----	--	--	--

Total Corridor Assessment (From Part VI above or a local site assessment)	160			
---	-----	--	--	--

TOTAL POINTS (Total of above 2 lines)	260			
--	------------	--	--	--

1. Corridor Selected:	2. Total Acres of Farmlands to be Converted by Project:	3. Date Of Selection:	4. Was A Local Site Assessment Used? YES <input type="checkbox"/> NO <input type="checkbox"/>
-----------------------	---	-----------------------	--

5. Reason For Selection:

Signature of Person Completing this Part:	DATE
---	------

Joshua Graham

NOTE: Complete a form for each segment with more than one Alternate Corridor



IN REPLY REFER TO:

United States Department of the Interior

FISH AND WILDLIFE SERVICE

Arkansas Ecological Service Field Office
110 South Amity Road, Suite 300
Conway, Arkansas 72032



August 18, 2020

Mr. John Fleming
c/o Bill Bailey
Arkansas Department of Transportation
10324 Interstate 30
Little Rock, Arkansas 72209

Consultation Code: 04ER1000-2020-SLI-1335

Dear Mr. Fleming:

The U.S. Fish and Wildlife Service (Service) has reviewed your request, assessment, and determinations for Arkansas Department of Transportation (ARDOT) Job Number 100955 - Little River in Mississippi County, Arkansas. We received your request and the associated determinations on August 17, 2020.

The project was described and assessed as follows (abbreviated):

Please review the attached documents and let us know if you concur with our determinations. Based on the lack of habitat and distance to known species, it is our determination that the proposed project will have “no effect” on the Eastern Black Rail, Piping Plover, Red Knot, and Scaleshell Mussel. Based on the distance to known species, it is our determination that the proposed project may affect, but is not likely to adversely affect the Fat Pockebook.

(A mussel survey was conducted and a report provided indicating that no federally or state listed species are in the immediate vicinity of the action.)

The Service reviewed your determination that the proposed action, “may affect, but is not likely to adversely affect,” Fat Pocketbook. The Service agrees with your assessment and concurs with your determination due to the limited habitat being directly affected along existing roadway and bridge/culvert crossings, negative federally listed mussel survey findings, the minimal nature of the action and minimal potential for indirect effects, existing turbidity and highly disturbed environment, the distance to known species locations, the implementation of hazardous material BMPs, and the standard provisions for stream sediment control and water quality conservation measures. This concurrence concludes your ESA Section 7 responsibilities relative to these species for this action.

Mr. John Fleming

2

For further assistance or if you have any questions, please contact Lindsey Lewis at (501) 513-4489 or lindsey_lewis@fws.gov.

Sincerely,

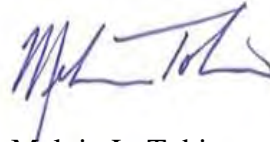
A handwritten signature in blue ink, appearing to read 'Melvin L. Tobin', with a stylized flourish at the end.

Melvin L. Tobin
Field Supervisor

cc: Project File
Read File

Filename: <C:\Users\lilewis\Documents\PROJECTS\FY2020\ARDOT\ARDOT Job 100955\AFO Letter - ARDOT 100955 - Little River - Comments.docx>



United States Department of the Interior



FISH AND WILDLIFE SERVICE
Arkansas Ecological Services Field Office
110 South Amity Suite 300
Conway, AR 72032-8975
Phone: (501) 513-4470 Fax: (501) 513-4480
<http://www.fws.gov/arkansas-es>

In Reply Refer To:

August 17, 2020

Consultation Code: 04ER1000-2020-SLI-1335

Event Code: 04ER1000-2020-E-03294

Project Name: 100955 Hwys. 77, 140, 158, & 181 Strs. & Apprs.

Subject: List of threatened and endangered species that may occur in your proposed project location, and/or may be affected by your proposed project

To Whom It May Concern:

The enclosed species list identifies endangered, threatened, proposed, and candidate species, as well as proposed and final designated critical habitat, that may occur within the boundary of your proposed project and/or may be affected by your proposed project. The species list fulfills the requirements of the U.S. Fish and Wildlife Service (Service) under section 7(c) of the Endangered Species Act (Act) of 1973, as amended (16 U.S.C. 1531 *et seq.*). **This letter only provides an official species list and technical assistance; if you determine that listed species and/or designated critical habitat may be affected in any way by the proposed project, even if the effect is wholly beneficial, consultation with the Service will be necessary.**

If you determine that this project will have no effect on listed species and their habitat in any way, then you have completed Section 7 consultation with the Service and may use this letter in your project file or application.

The purpose of the Act is to provide a means whereby threatened and endangered species and the ecosystems upon which they depend may be conserved. Under sections 7(a)(1) and 7(a)(2) of the Act and its implementing regulations (50 CFR 402 *et seq.*), federal agencies are required to utilize their authorities to carry out programs for the conservation of threatened and endangered species and to determine whether projects may affect threatened and endangered species and/or designated critical habitat. More information on the regulations and procedures for section 7 consultation, including the role of permit or license applicants, can be found on our website.

Please visit our website at <http://www.fws.gov/arkansas-es/IPaC/home.html> for species-specific guidance to avoid and minimize adverse effects to federally endangered,

threatened, proposed, and candidate species. Our web site also contains additional information on species life history and habitat requirements that may be useful in project planning.

If your project involves in-stream construction activities, oil and natural gas infrastructure, road construction, transmission lines, or communication towers, please review our project specific guidance at <http://www.fws.gov/arkansas-es/IPaC/ProjSpec.html>.

The karst region of Arkansas is a unique region that covers the **northern third of Arkansas** and we have specific guidance to conserve sensitive cave-obligate and bat species. **Please visit <http://www.fws.gov/arkansas-es/IPaC/Karst.html> to determine if your project occurs in the karst region and to view karst specific-guidance.** Proper implementation and maintenance of best management practices specified in these guidance documents is necessary to avoid adverse effects to federally protected species and often avoids the more lengthy formal consultation process.

If your species list includes any mussels, Northern Long-eared Bat, Indiana Bat, Yellowcheek Darter, Red-cockaded Woodpecker, or American Burying Beetle, your project may require a presence/absence and/or habitat survey prior to commencing project activities. Please check the appropriate species-specific guidance on our website to determine if your project requires a survey. We strongly recommend that you contact the appropriate staff species lead biologist (see office directory or species page) prior to conducting presence/absence surveys to ensure the appropriate level of effort and methodology.

Under the ESA, it is the responsibility of the Federal action agency or its designated representative to determine if a proposed action "may affect" endangered, threatened, or proposed species, or designated critical habitat, and if so, to consult with the Service further. Similarly, it is the responsibility of the Federal action agency or project proponent, not the Service, to make "no effect" determinations. If you determine that your proposed action will have "no effect" on threatened or endangered species or their respective critical habitat, you do not need to seek concurrence with the Service. Nevertheless, it is a violation of Federal law to harm or harass any federally-listed threatened or endangered fish or wildlife species without the appropriate permit.

Through the consultation process, we will analyze information contained in a biological assessment that you provide. If your proposed action is associated with Federal funding or permitting, consultation will occur with the Federal agency under section 7(a)(2) of the ESA. Otherwise, an incidental take permit pursuant to section 10(a)(1)(B) of the ESA (also known as a habitat conservation plan) is necessary to harm or harass federally listed threatened or endangered fish or wildlife species. In either case, there is no mechanism for authorizing incidental take "after-the-fact." For more information regarding formal consultation and HCPs, please see the Service's Consultation Handbook and Habitat Conservation Plans at www.fws.gov/endangered/esa-library/index.html#consultations.

New information based on updated surveys, changes in the abundance and distribution of species, changed habitat conditions, or other factors could change this list. Please feel free to contact us if you need more current information or assistance regarding the potential impacts to

federally proposed, listed, and candidate species and federally designated and proposed critical habitat. Please note that under 50 CFR 402.12(e) of the regulations implementing section 7 of the Act, **the accuracy of this species list should be verified after 90 days**. This verification can be completed formally or informally as desired. The Service recommends that verification be completed by visiting the ECOS-IPaC website at regular intervals during project planning and implementation for updates to species lists and information. An updated list may be requested through the ECOS-IPaC system by completing the same process used to receive the enclosed list.

We appreciate your concern for threatened and endangered species. The Service encourages Federal agencies to include conservation of threatened and endangered species into their project planning to further the purposes of the Act. **Please include the Consultation Tracking Number in the header of this letter with any request for consultation or correspondence about your project that you submit to our office.**

Attachment(s):

- Official Species List
-

Official Species List

This list is provided pursuant to Section 7 of the Endangered Species Act, and fulfills the requirement for Federal agencies to "request of the Secretary of the Interior information whether any species which is listed or proposed to be listed may be present in the area of a proposed action".

This species list is provided by:

Arkansas Ecological Services Field Office

110 South Amity Suite 300

Conway, AR 72032-8975

(501) 513-4470

Project Summary

Consultation Code: 04ER1000-2020-SLI-1335

Event Code: 04ER1000-2020-E-03294

Project Name: 100955 Hwys. 77, 140, 158, & 181 Strs. & Apprs.

Project Type: TRANSPORTATION

Project Description: replace 14 drainage structures and/or bridges

Project Location:

Approximate location of the project can be viewed in Google Maps: <https://www.google.com/maps/place/35.76807363063406N90.17350506004053W>

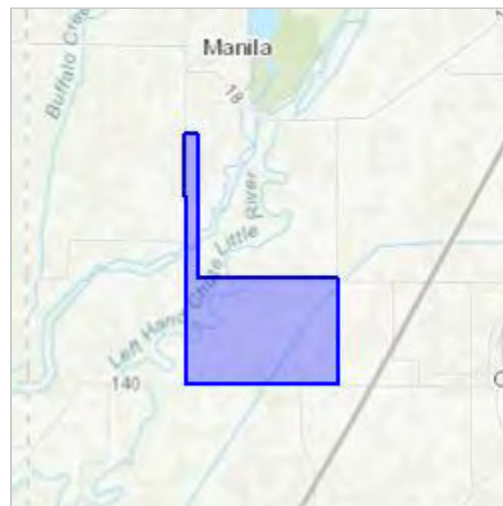

Counties: Mississippi, AR

Endangered Species Act Species

There is a total of 5 threatened, endangered, or candidate species on this species list.

Species on this list should be considered in an effects analysis for your project and could include species that exist in another geographic area. For example, certain fish may appear on the species list because a project could affect downstream species.

IPaC does not display listed species or critical habitats under the sole jurisdiction of NOAA Fisheries¹, as USFWS does not have the authority to speak on behalf of NOAA and the Department of Commerce.

See the "Critical habitats" section below for those critical habitats that lie wholly or partially within your project area under this office's jurisdiction. Please contact the designated FWS office if you have questions.

-
1. [NOAA Fisheries](#), also known as the National Marine Fisheries Service (NMFS), is an office of the National Oceanic and Atmospheric Administration within the Department of Commerce.

Birds

NAME	STATUS
Eastern Black Rail <i>Laterallus jamaicensis ssp. jamaicensis</i> No critical habitat has been designated for this species. Species profile: https://ecos.fws.gov/ecp/species/10477	Proposed Threatened
Piping Plover <i>Charadrius melodus</i> Population: [Atlantic Coast and Northern Great Plains populations] - Wherever found, except those areas where listed as endangered. There is final critical habitat for this species. Your location is outside the critical habitat. Species profile: https://ecos.fws.gov/ecp/species/6039	Threatened
Red Knot <i>Calidris canutus rufa</i> No critical habitat has been designated for this species. Species profile: https://ecos.fws.gov/ecp/species/1864	Threatened

Clams

NAME	STATUS
Fat Pocketbook <i>Potamilus capax</i> No critical habitat has been designated for this species. Species profile: https://ecos.fws.gov/ecp/species/2780	Endangered
Scaleshell Mussel <i>Leptodea leptodon</i> No critical habitat has been designated for this species. Species profile: https://ecos.fws.gov/ecp/species/5881	Endangered

Critical habitats

THERE ARE NO CRITICAL HABITATS WITHIN YOUR PROJECT AREA UNDER THIS OFFICE'S JURISDICTION.

**ARDOT ENVIRONMENTAL VERIFICATION CHECKLIST
FOR CONSIDERATION OF POTENTIAL IMPACTS**

ARDOT Job Number 100955 FAP Number NHPP-CHBP-0047(81)

Job Title Hwys. 77, 140, 158, & 181 Strs. & Apprs. (Mississippi Co.) (S)

Environmental Resource	None	Minimal	Major	Comments-required for each item
Air Quality	X			No MSAT concerns or impacts expected
Cultural Resources	X			SHPO clearance attached
Economic	X			No adverse impacts expected
Endangered Species		X		USFWS concurrence 8/18/2020 attached
Environmental Justice/Title VI	X			EJ populations not identified in area
Fish and Wildlife		X		Temporary during construction
Floodplains	X			SP included in contract for 6 of 7 Hwy. 77 structures
Forest Service Property	X			Not within federal or state forest
Hazardous Materials/Landfills	X			None identified in project area
Land Use		X		20.3 acres of proposed ROW
Migratory Birds		X		Migratory Bird SP included
Navigation/Coast Guard	X			None in the project area
Noise Levels	X			Noise analysis not required
Prime Farmland		X		7.0 acres of Prime Farmland converted to highway ROW
Protected Waters	X			Tyronza River has TMDL for turbidity; WPC SP
Public Recreation Lands	X			None in project area
Public Water Supply/WHPA	X			WHP SP included
Relocates	X			Relocations not required
Section 4(f)/6(f)	X			4(f)/6(f) resources not in project area
Social	X			No adverse impacts expected
Underground Storage Tanks	X			None identified in project area
Visual	X			No adverse impacts expected
Streams		X		NW14; < 0.1 acre of stream impacts
Water Quality		X		Temporary during construction
Wetlands	X			None in the project area
Wildlife Refuges	X			None in the project area

Section 401 Water Quality Certification Required? Yes
 Short-term Activity Authorization Required? Yes
 Section 404 Permit Required? Yes Type NW14

Remarks: Job requires wellhead protection SP for offsite areas, coordination with ADH, and individual water quality cert for turbidity impairment.

Signature of Evaluator Mary Pearson Date 10/26/2020

PROJECT DESIGN CRITERIA

DATE: October 2, 2020
 REV.: _____

JOB NO: 100955 ROUTE / SECTION: Various LENGTH: 2.35 miles COUNTY: Mississippi
 JOB NAME: Hwys. 77, 140, 158, & 181 Strs. & Apprs. (Mississippi Co.) (S) MIN ORDER: 2018-080
 2021 ADT: 1,900 2041 ADT: 2,300 TRUCK: 6% 4-LANE GRID SYSTEM: No
 APHN: No INCENTIVE/DISINCENTIVE: No FUNCTIONAL CLASSIFICATION: Major Collector

EXISTING CONDITIONS

ROADWAY WIDTH: 28' WIDTH OF TRAVELED WAY: 20' SHOULDERS (WIDTH/TYPE): 4' unpaved⁽¹⁾, 4'(2' pav.)⁽²⁾
 BIKE/PED ACCOMMODATIONS: No CRASH RATE: 0.77 STATEWIDE CRASH RATE: 1.06

BRIDGE INFORMATION

Bridge No.	Log Mile	Length x Width	Structure Type	BCI	Deck/Culvert Rating	Superstructure Rating	Substructure Rating	Posted
02138 ⁽¹⁾	0.71	54.0' x 26.5'	Concrete Slab	57.11	7	7	4	5
02873 ⁽²⁾	5.97	122.0' x 28.8'	Steel Multi-Beam	26.35	5	4	5	0
02881 ⁽²⁾	6.34	362.0' x 28.5'	Steel Multi-Beam	46.85	5	5	5	1
02872 ⁽²⁾	6.76	202.0' x 28.7'	Steel Multi-Beam	29.32	5	3	5	0
02871 ⁽²⁾	6.83	322.0' x 28.7'	Steel Multi-Beam	29.96	5	4	5	0
02870 ⁽²⁾	7.16	202.0' x 28.5'	Steel Multi-Beam	64.26	5	4	5	5
02141 ⁽²⁾	10.42	144.0' x 26.6'	Concrete Slab	58.03	6	6	4	5
M2231 ⁽⁴⁾	4.08	44.0' x 25.0'	Timber Multi-Beam	19.67	6	5	4	0
M2232 ⁽⁴⁾	0.49	45.0' x 25.2'	Concrete Channel Beam	34.29	4	3	5	0

Refer to PDC Bridge Information Codes

RECOMMENDED CRITERIA

NO. OF LANES: 2 WIDTH: 11' SHOULDERS (WIDTH/TYPE): 6' (2' paved)
 DIVIDED: No MEDIAN WIDTH: N/A PARKING: N/A
 BRIDGE WIDTHS: 34' DESIGN SPEED - RURAL: 55 MPH URBAN: N/A
 DEGREE OF ACCESS CONTROL: N/A CLEAR ZONE: 30' @ 4:1 / 22' @ 6:1
 LOCATION OF INTERCHANGES: N/A CHANNELIZED INTERSECTION: As Warranted
 TRAFFIC SIGNALS: As Warranted RR X-ING PROTECTION: N/A
 BIKE/PED ACCOMMODATIONS: No
 PREVIOUS PLANNING STUDY: No
 STUDY FINDING: N/A

RECOMMENDED TYPE FUNDS: NHPP
⁽³⁾ PRELIM COST ESTIMATE: ROADWAY: \$10,900,000 BRIDGE: \$13,500,000 TOTAL: \$24,400,000

REMARKS:

Data and Criteria pertains to Highway 77. Criteria for Highway 158, Highway 181, and Highway 140 previously approved under previous projects 100763 and 100996.

⁽¹⁾ R.C. Box Culvert, ⁽²⁾ Bridge Replacement

⁽¹⁾ Highway 77 - L.M. 0.71, ⁽²⁾ Highway 77 - L.M. 5.97 - 10.42

⁽³⁾ Preliminary cost estimate represents all structure replacements on all routes

⁽⁴⁾ Highway 181

Note: Bridge M2094 is to be constructed by District 10 forces

Use AASHTO Green Book

RECOMMENDED BY:

Charles Ellis: Charles R Ellis Trinity Smith: Trinity Smith
 Date: 10/5/2020 Date: 10-2-2020

APPROVED BY:

Mike Fugett:  Date: 10-5-2020
 ACE-Design

(ATTACH NEW PROJECT MEMO, LOCATION MAP, AND CRASH ANALYSIS)

PROJECT DESIGN CRITERIA

DATE: June 27, 2019

REV.: _____

JOB NO:	<u>100763</u>	ROUTE / SECTION:	<u>158 / 1</u>	LENGTH:	<u>0.52 mile</u>	COUNTY:	<u>Mississippi</u>
JOB NAME:	<u>National Ditch No. 6 Str. & Apprs. (S)</u>					MIN ORDER:	<u>2016-048</u>
2020 ADT:	<u>550</u>	2040 ADT:	<u>600</u>	TRUCK:	<u>3%</u>	4-LANE GRID SYSTEM:	<u>No</u>
APHN:	<u>No</u>	INCENTIVE/DISINCENTIVE:	<u>No</u>	FUNCTIONAL CLASSIFICATION:	<u>Major Collector</u>		

EXISTING CONDITIONS

ROADWAY WIDTH:	<u>30'</u>	WIDTH OF TRAVELED WAY:	<u>20'</u>	SHOULDERS (WIDTH/TYPE):	<u>5' Unpaved</u>
CRASH RATE:	<u>1.10</u>	STATEWIDE CRASH RATE:	<u>1.07</u>		

BRIDGE INFORMATION

Bridge No.	Log Mile	Length x Width	Structure Type	BCI	Deck Rating	Superstructure Rating	Substructure Rating	Posted
M4039	10.33	232.0' x 31.0'	Steel Multi-Beam	32.12	3	4	4	0

* Refer to PDC Bridge Information Codes

RECOMMENDED CRITERIA

NO. OF LANES:	<u>2</u>	WIDTH:	<u>11'</u>	SHOULDERS (WIDTH/TYPE):	<u>4' (2' Paved)</u>
DIVIDED:	<u>N/A</u>	MEDIAN WIDTH:	<u>N/A</u>	PARKING:	<u>No</u>
BRIDGE WIDTHS:	<u>30'</u>	DESIGN SPEED - RURAL:	<u>60 mph</u>	URBAN:	<u>N/A</u>
DEGREE OF ACCESS CONTROL:	<u>None</u>	CLEAR ZONE:	<u>4:1 - 24'</u> <u>6:1 - 18'</u>		
LOCATION OF INTERCHANGES:	<u>N/A</u>	CHANNELIZED INTERSECTION:	<u>N/A</u>		
TRAFFIC SIGNALS:	<u>N/A</u>	RR X-ING PROTECTION:	<u>N/A</u>		
PREVIOUS PLANNING STUDY:	<u>None</u>				
STUDY FINDING:	<u>N/A</u>				

RECOMMENDED TYPE FUNDS:	<u>NHPP</u>
PRELIM COST ESTIMATE:	ROADWAY: <u>\$1,000,000</u> BRIDGE: <u>\$1,200,000</u> TOTAL: <u>\$2,200,000</u>

REMARKS:

Bridge Replacement.

Use AASHTO Green Book

RECOMMENDED BY:

Charles Ellis: 
Date: 7/2/19

Trinity Smith: 
Date: 6/27/19

APPROVED BY:

Mike Fugett: 
ACE-Design

Date: 7/5/19

(ATTACH NEW PROJECT MEMO, LOCATION MAP, AND CRASH ANALYSIS)

PROJECT DESIGN CRITERIA

NOTE: Design Criteria included with CE to provide Hwy. 181 information

DATE: June 24, 2019
REV.:

JOB NO:	<u>100986</u>	ROUTE / SECTION:	<u>140 / 2 181/1</u>	LENGTH:	<u>1.58 mile</u>	COUNTY:	<u>Mississippi</u>
JOB NAME:	<u>Hwy. 140 Strs. & Apprs. (S)</u>					MIN ORDER:	<u>2018-080</u>
2021 ADT:	<u>3300 950</u>	2041 ADT:	<u>4000 1000</u>	TRUCK:	<u>17% 7%</u>	4-LANE GRID SYSTEM:	<u>No</u>
APHN:	<u>Yes No</u>	INCENTIVE/DISINCENTIVE:	<u>No</u>	FUNCTIONAL CLASSIFICATION:	<u>Minor Arterial Major Collector</u>		

EXISTING CONDITIONS

ROADWAY WIDTH:	<u>Site 1: 34' Site 2: 34' Site 3: 30' Site 4: 28'</u>	WIDTH OF TRAVELED WAY:	<u>Site 1: 22' Site 2: 20' Site 3: 20' Site 4: 20'</u>	SHOULDERS (WIDTH/TYPE):	<u>Site 1: 6' Paved Site 2: 7' Paved Site 3: 5' Paved Site 4: 3' Paved</u>
CRASH RATE:	<u>1.74</u>	STATEWIDE CRASH RATE:	<u>1.07</u>		

BRIDGE INFORMATION

Bridge No.	Log Mile	Length x Width	Structure Type	BCI	Deck/Culvert Rating	Superstructure Rating	Substructure Rating	Posted
03781	9.08	228.0' x 33.7'	Steel Multi-Beam	80.38	4	5	5	5
03782	10.52	228.0' x 33.7'	Steel Multi-Beam	80.58	4	5	5	5
X0345	12.11	21.0' x 0.0'	Concrete & Steel Culvert	63.47	4	N/A	N/A	5

* Refer to PDC Bridge Information Codes

RECOMMENDED CRITERIA

NO. OF LANES:	<u>2</u>	WIDTH:	<u>Sites 1-3: 12' Site 4: 11'</u>	SHOULDERS (WIDTH/TYPE):	<u>Sites 1-3: 8' Paved Site 4: 4' Paved</u>
DIVIDED:	<u>No</u>	MEDIAN WIDTH:	<u>N/A</u>		
BRIDGE WIDTHS:	<u>Sites 1 & 2: 40'</u>	DESIGN SPEED - RURAL:	<u>60 mph</u>	URBAN:	<u>N/A</u>
DEGREE OF ACCESS CONTROL:	<u>Uncontrolled</u>	CLEAR ZONE:	<u>4:1 - 30'</u>		
LOCATION OF INTERCHANGES:	<u>N/A</u>	CHANNELIZED INTERSECTION:	<u>N/A</u>		
TRAFFIC SIGNALS:	<u>None</u>	RR X-ING PROTECTION:	<u>N/A</u>		
PREVIOUS PLANNING STUDY:	<u>None</u>				
STUDY FINDING:	<u>N/A</u>				

RECOMMENDED TYPE FUNDS: NHPP

PRELIM COST ESTIMATE: ROADWAY: \$5,600,000 BRIDGE: \$3,100,000 TOTAL: \$8,700,000

REMARKS:

- R.C. Box Culvert (Sites 3 & 4)
- Use AASHTO Green Book
- Site 1 = Hwy. 140 Log Mile 8.71 - Log Mile 9.46
- Site 2 = Hwy. 140 Log Mile 10.15 - Log Mile 10.90
- Site 3 = Hwy. 140 Log Mile 12.09 - Log Mile 12.13
- Site 4 = Hwy. 181 Log Mile 5.89 - Log Mile 5.93

RECOMMENDED BY:

Charles Ellis: *Charles R. Ellis*
Date: 7/1/19

Trinity Smith: *Trinity Smith*
Date: 6/24/19

APPROVED BY:

Mike Fugett: *[Signature]*
ACE-Design

Date: 7-2-19

(ATTACH NEW PROJECT MEMO, LOCATION MAP, AND CRASH ANALYSIS)