

FED. DIST. NO.	STATE	PROJ. NO.	FISCAL YEAR	SHEET NO.	TOTAL SHEETS
6	ARK.	N.R.S. 350-B	1935	14	65

State Job No. 2216

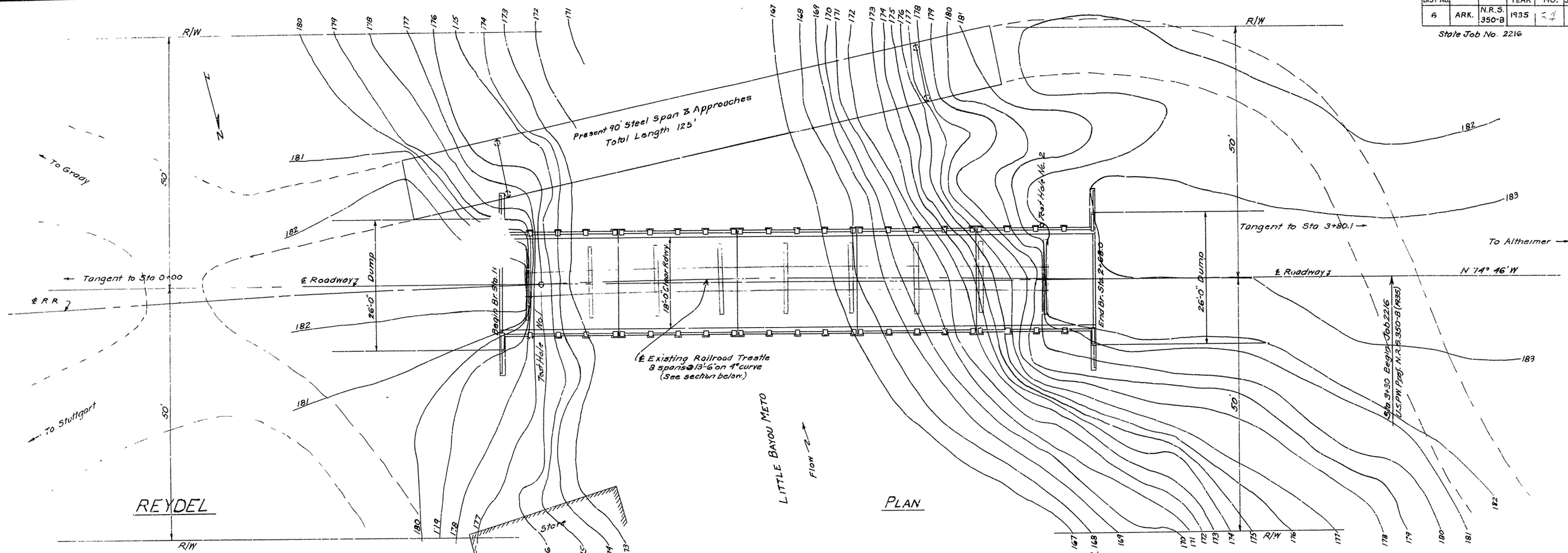

PLAN

QUANTITIES - BRIDGE No. 1933

Item No. 13	Dry Excavation For Structures	40 Cu. Yds.
" 91	Class 'S' Concrete for Bridges	61.18 Cu. Yds.
" 92	Reinforcing Steel for Bridges	13,724 Lbs.
" 94	Concrete Railing for Bridges	259 Lin. Ft.
" 96	Structural Steel in Beam Spans	34,416 Lbs.
" 97	SP Treated Bridge Timber	2,482 M.F.T.B.M.
" 98	Treated Timber Piling	828 Lin. Ft.
" 99	Treated Timber Pile Cut-off	56 Lin. Ft.
" S.P.	Bronze State Bridge Name Plates (Type B)	1 Each
" S.R.	Removal of Existing Structures and Maintaining Traffic	Lump Sum

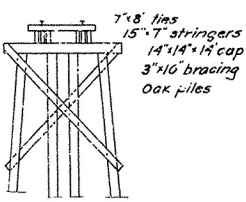

TYPICAL SECTION OF R.R. TRESTLE
3 spans @ 13'-6" on 4" curve

B.M. #1 Gov't. B.M. 50' L.Y.
Sta. 3+70, Elev. 182.05

Note: Lengths of piles shown are for estimating quantities only.
Actual lengths are to be determined in the field.
For details of standard 25" C I-Beam Span, See Dwg. No. 2136
Drainage Area indeterminate. Present bridge openings carry high water.
Flood route across Little Bayou Meto at intersection with Arkansas River approximately two miles down stream

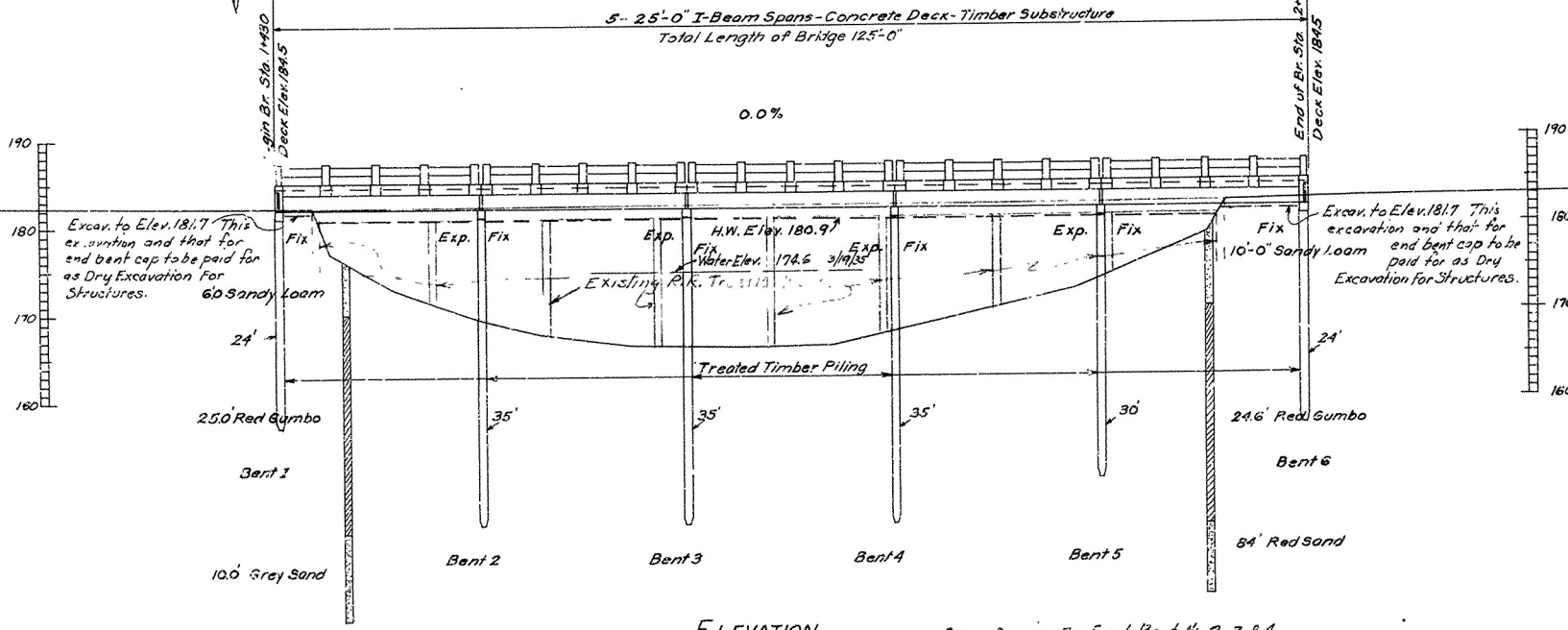

ELEVATION

Sway Bracing For Each Bent No. 2, 3, & 4
2.3"x10" x 24'-0"

LAYOUT OF BRIDGE OVER LITTLE BAYOU METO AT REYDEL, ARK. JEFFERSON CO. ROUTE SEC.

ARKANSAS STATE HIGHWAY COMMISSION
LITTLE ROCK, ARK.

Drawn By: B.V. Date: 2-25-35
Traced By: B.V. Date: 2-26-35
Checked By: B.V. Date: 2-26-35
Scale: 1"=10'-0"

BRIDGE No. 1933 DRAWING No. 3976

N.B. Lerner
BRIDGE ENGINEER

